

ELEVATION CERTIFICATE

OMB No. 1660-0008
Expires March 31, 2012

Important: Read the instructions on pages 1-9.

SECTION A - PROPERTY INFORMATION		For Insurance Company Use:
A1. Building Owner's Name <u>Robert & Rita Widergren</u>	Policy Number _____	
A2. Building Street Address (including Apt., Unit, Suite, and/or Bldg. No.) or P.O. Route and Box No. <u>479 Fairway Drive</u>	Company NAIC Number _____	
City <u>Novato</u> State <u>CA</u> ZIP Code <u>94949</u>		
A3. Property Description (Lot and Block Numbers, Tax Parcel Number, Legal Description, etc.) <u>Lot 197, Map of Marin Golf & Country Club Estates, Unit 4, 10 Maps 48, Marin County Records.</u>		
A4. Building Use (e.g., Residential, Non-Residential, Addition, Accessory, etc.) <u>Residential</u>		
A5. Latitude/Longitude: Lat. <u>38.06192</u> Long. <u>-122.57123</u>		Horizontal Datum: <input type="checkbox"/> NAD 1927 <input checked="" type="checkbox"/> NAD 1983
A6. Attach at least 2 photographs of the building if the Certificate is being used to obtain flood insurance.		
A7. Building Diagram Number <u>1A</u>		
A8. For a building with a crawlspace or enclosure(s):		A9. For a building with an attached garage:
a) Square footage of crawlspace or enclosure(s) <u>2467</u> sq ft	a) Square footage of attached garage <u>502</u> sq ft	
b) No. of permanent flood openings in the crawlspace or enclosure(s) within 1.0 foot above adjacent grade <u>23</u>	b) No. of permanent flood openings in the attached garage within 1.0 foot above adjacent grade <u>4</u>	
c) Total net area of flood openings in A8.b <u>1771</u> sq in	c) Total net area of flood openings in A9.b <u>336</u> sq in	
d) Engineered flood openings? <input type="checkbox"/> Yes <input checked="" type="checkbox"/> No	d) Engineered flood openings? <input type="checkbox"/> Yes <input checked="" type="checkbox"/> No	

SECTION B - FLOOD INSURANCE RATE MAP (FIRM) INFORMATION

B1. NFIP Community Name & Community Number <u>City of Novato 060178</u>		B2. County Name <u>Marin</u>	B3. State <u>CA</u>
B4. Map/Panel Number <u>0287</u>	B5. Suffix <u>D</u>	B6. FIRM Index Date <u>May 4, 2009</u>	B7. FIRM Panel Effective/Revised Date <u>May 4, 2009</u>
B8. Flood Zone(s) <u>AE</u>		B9. Base Flood Elevation(s) (Zone AO, use base flood depth) <u>E1=143.9</u>	

- B10. Indicate the source of the Base Flood Elevation (BFE) data or base flood depth entered in Item B9.
 FIS Profile FIRM Community Determined Other (Describe) _____
- B11. Indicate elevation datum used for BFE in Item B9: NGVD 1929 NAVD 1988 Other (Describe) _____
- B12. Is the building located in a Coastal Barrier Resources System (CBRS) area or Otherwise Protected Area (OPA)? Yes No
 Designation Date _____ CBRS OPA

SECTION C - BUILDING ELEVATION INFORMATION (SURVEY REQUIRED)

- C1. Building elevations are based on: Construction Drawings* Building Under Construction* Finished Construction
 *A new Elevation Certificate will be required when construction of the building is complete.
- C2. Elevations – Zones A1-A30, AE, AH, A (with BFE), VE, V1-V30, V (with BFE), AR, AR/A, AR/AE, AR/A1-A30, AR/AH, AR/AO. Complete Items C2.a-h below according to the building diagram specified in Item A7. Use the same datum as the BFE.
 Benchmark Utilized NAVD 1988 Vertical Datum NAVD 1988
 Conversion/Comments _____
- Check the measurement used.
- | | |
|---|---|
| a) Top of bottom floor (including basement, crawlspace, or enclosure floor) <u>143.7</u> | <input checked="" type="checkbox"/> feet <input type="checkbox"/> meters (Puerto Rico only) |
| b) Top of the next higher floor <u>144.9</u> | <input checked="" type="checkbox"/> feet <input type="checkbox"/> meters (Puerto Rico only) |
| c) Bottom of the lowest horizontal structural member (V Zones only) _____ | <input type="checkbox"/> feet <input type="checkbox"/> meters (Puerto Rico only) |
| d) Attached garage (top of slab) <u>143.4</u> | <input checked="" type="checkbox"/> feet <input type="checkbox"/> meters (Puerto Rico only) |
| e) Lowest elevation of machinery or equipment servicing the building (Describe type of equipment and location in Comments) <u>143.7</u> | <input checked="" type="checkbox"/> feet <input type="checkbox"/> meters (Puerto Rico only) |
| f) Lowest adjacent (finished) grade next to building (LAG) <u>143.2</u> | <input checked="" type="checkbox"/> feet <input type="checkbox"/> meters (Puerto Rico only) |
| g) Highest adjacent (finished) grade next to building (HAG) <u>144.8</u> | <input checked="" type="checkbox"/> feet <input type="checkbox"/> meters (Puerto Rico only) |
| h) Lowest adjacent grade at lowest elevation of deck or stairs, including structural support <u>NA</u> | <input checked="" type="checkbox"/> feet <input type="checkbox"/> meters (Puerto Rico only) |

SECTION D - SURVEYOR, ENGINEER, OR ARCHITECT CERTIFICATION

This certification is to be signed and sealed by a land surveyor, engineer, or architect authorized by law to certify elevation information. I certify that the information on this Certificate represents my best efforts to interpret the data available. I understand that any false statement may be punishable by fine or imprisonment under 18 U.S. Code, Section 1001.

- Check here if comments are provided on back of form. Were latitude and longitude in Section A provided by a licensed land surveyor? Yes No

Certifier's Name <u>Dale White</u>	License Number <u>LS 4397</u>
Title <u>Partner</u>	Company Name <u>WHITE & PRESCOTT</u>
Address <u>1620 Grant Avenue #8</u>	City <u>Novato</u> State <u>CA</u> ZIP Code <u>94945</u>
Signature _____	Date <u>09-13-2012</u> Telephone <u>415-897-7730</u>

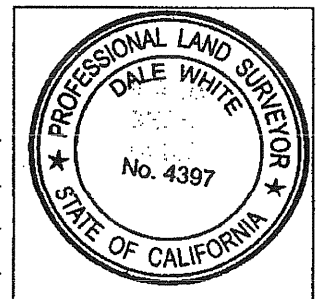

IMPORTANT: In these spaces, copy the corresponding information from Section A.

Building Street Address (including Apt., Unit, Suite, and/or Bldg. No.) or P.O. Route and Box No.
479 Fairway Drive

City Novato State CA ZIP Code 94949

For Insurance Company Use:

Policy Number

Company NAIC Number

SECTION D - SURVEYOR, ENGINEER, OR ARCHITECT CERTIFICATION (CONTINUED)

Copy both sides of this Elevation Certificate for (1) community official, (2) insurance agent/company, and (3) building owner.

Comments Section A8, b) & c): There are 4 vent openings that are approx. 1.3' above adjacent grade (308 sq. in. total area). The foundation is solid concrete below the vent openings.

Section C2, e): The water heater is located in a utility room off the back of the garage.

Dale White
Signature Dale White

Date 09-13-2012

Check here if attachments

SECTION E - BUILDING ELEVATION INFORMATION (SURVEY NOT REQUIRED) FOR ZONE AO AND ZONE A (WITHOUT BFE)

For Zones AO and A (without BFE), complete Items E1-E5. If the Certificate is intended to support a LOMA or LOMR-F request, complete Sections A, B, and C. For Items E1-E4, use natural grade, if available. Check the measurement used. In Puerto Rico only, enter meters.

E1. Provide elevation information for the following and check the appropriate boxes to show whether the elevation is above or below the highest adjacent grade (HAG) and the lowest adjacent grade (LAG).

a) Top of bottom floor (including basement, crawlspace, or enclosure) is _____ feet meters above or below the HAG.

b) Top of bottom floor (including basement, crawlspace, or enclosure) is _____ feet meters above or below the LAG.

E2. For Building Diagrams 6-9 with permanent flood openings provided in Section A Items 8 and/or 9 (see pages 8-9 of Instructions), the next higher floor (elevation C2.b in the diagrams) of the building is _____ feet meters above or below the HAG.

E3. Attached garage (top of slab) is _____ feet meters above or below the HAG.

E4. Top of platform of machinery and/or equipment servicing the building is _____ feet meters above or below the HAG.

E5. Zone AO only: If no flood depth number is available, is the top of the bottom floor elevated in accordance with the community's floodplain management ordinance? Yes No Unknown. The local official must certify this information in Section G.

SECTION F - PROPERTY OWNER (OR OWNER'S REPRESENTATIVE) CERTIFICATION

The property owner or owner's authorized representative who completes Sections A, B, and E for Zone A (without a FEMA-issued or community-issued BFE) or Zone AO must sign here. The statements in Sections A, B, and E are correct to the best of my knowledge.

Property Owner's or Owner's Authorized Representative's Name

Dale White

Address 1620 Grant Avenue, Ste. #8

City Novato

State CA

ZIP Code 94945

Signature

Dale White

Date 09-13-2012

Telephone 415-897-7730

Comments

Check here if attachments

SECTION G - COMMUNITY INFORMATION (OPTIONAL)

The local official who is authorized by law or ordinance to administer the community's floodplain management ordinance can complete Sections A, B, C (or E), and G of this Elevation Certificate. Complete the applicable item(s) and sign below. Check the measurement used in Items G8 and G9.

G1. The information in Section C was taken from other documentation that has been signed and sealed by a licensed surveyor, engineer, or architect who is authorized by law to certify elevation information. (Indicate the source and date of the elevation data in the Comments area below.)

G2. A community official completed Section E for a building located in Zone A (without a FEMA-issued or community-issued BFE) or Zone AO.

G3. The following information (Items G4-G9) is provided for community floodplain management purposes.

G4. Permit Number	G5. Date Permit Issued	G6. Date Certificate Of Compliance/Occupancy Issued
-------------------	------------------------	---

G7. This permit has been issued for: New Construction Substantial Improvement

G8. Elevation of as-built lowest floor (including basement) of the building: _____ feet meters (PR) Datum _____

G9. BFE or (in Zone AO) depth of flooding at the building site: _____ feet meters (PR) Datum _____

G10. Community's design flood elevation _____ feet meters (PR) Datum _____

Local Official's Name

Title

Community Name

Telephone

Signature

Date

Comments

Check here if attachments