



CITY OF NOVATO
CALIFORNIA



Harris & Associates

CITY OF NOVATO

ENGINEER'S REPORT

FISCAL YEAR 2021-22

SAN MARIN

LANDSCAPE ASSESSMENT DISTRICT A-81

SPECIAL DISTRICT #109054

FUND #222

JUNE 2021

PREPARED BY

Harris & Associates

22 Executive Park, Suite 200

Irvine, CA 92614

www.weareharris.com



CERTIFICATIONS

Certifications

I HEREBY CERTIFY that the enclosed Engineer's Report, together with Assessment and Assessment Diagram thereto attached was filed with me on the 23rd day of June, 2021.

Laura McDowall, City Clerk
City of Novato, Marin County, CA

I HEREBY CERTIFY that the enclosed Engineer's Report, together with Assessment and Assessment Diagram thereto attached was approved and confirmed by the City Council of the City of Novato, California on the 22nd day of June, 2021.

Laura McDowall, City Clerk
City of Novato, Marin County, CA



TABLE OF CONTENTS

Table of Contents

STATEMENT OF ASSESSMENT ENGINEER

PART I – OVERVIEW _____ 1

PART II – PLANS AND SPECIFICATIONS _____ 2

PART III – ESTIMATE OF COSTS _____ 4

PART IV – METHOD OF APPORTIONMENT _____ 7

APPENDIX A – PROPOSITION 218 COMPLIANCE RECORD

APPENDIX B – DISTRICT DIAGRAM

APPENDIX C – ASSESSMENT ROLL



ENGINEER'S CERTIFICATION

Statement of Assessment Engineer

AGENCY: THE CITY OF NOVATO

PROJECT: SAN MARIN LANDSCAPE ASSESSMENT DISTRICT (A-81)

TO: THE CITY COUNCIL OF THE
CITY OF NOVATO
STATE OF CALIFORNIA

ENGINEER'S REPORT FOR FISCAL YEAR 2021-22

The preparation of this Annual Engineer's Report ("Report") is in conformance with the obligation of the City Council for the San Marin Landscape Assessment District of the City of Novato to provide landscaping services upon each lot or parcel of land in the district in proportion to the estimated benefit to be received by each such lot or parcel of land for Fiscal Year 2021-22.

Pursuant to the Landscaping and Lighting Act of 1972 (Part 2 Division 15 of the Streets and Highways Code of the State of California, commencing with Section 22500) ("Act"), Article XIID, Section 4(a) of the State of California Constitution, and in accordance with the City of Novato's Resolution being adopted by the City Council on the 22nd day of June, 2021, this Report has been ordered for:

SAN MARIN LANDSCAPE ASSESSMENT DISTRICT (A-81)

(Hereinafter referred to as the "District"),

I, Anna C. Tan-Gatue, authorized representative of the District, the duly appointed Assessment Engineer submit the following Report which consists of the following four (4) parts and Appendices:

PART I

Overview: This part provides a general description of the District, Proposition 218 and a summary of the proposed assessment.

PART II

Plans and Specifications: This part provides a general description of improvements proposed to be maintained in the District. Plans and specifications for the improvements are on file with the City.



PART III

Estimate of Cost: This part contains the cost estimate of the proposed maintenance including incidental costs and expenses for Fiscal Year 2021-22. This section also includes a financial summary of the prior year budget.

PART IV

Method of Apportionment of the Assessments: This part describes the method of apportionment of assessments, based upon parcel classification of land within the District in proportion to the estimated special benefits to be received. The costs and expenses of the District have been assessed upon the parcels of land within the boundaries of District pursuant to the initial methodology established at the time of formation. For particulars as to the identification of parcels, reference is made to the District Diagram.

Appendices

- Appendix A – Proposition 218 Compliance
- Appendix B – District Diagram
- Appendix C – Assessment Roll

In conclusion, it is my opinion that the costs and expenses of the District have been assessed to the lots and parcels within the boundaries of the District in proportion to the estimated benefits to be received by each lot or parcel from the services provided.

DATED this 17th day of June, 2021



Harris & Associates



Anna C. Tan-Gatue, P.E., Assessment Engineer
R.I.E. No. 14356
Engineer of Work



PART I – OVERVIEW

Overview

GENERAL DESCRIPTION OF THE DISTRICT

The San Marin area was developed in the 1960s and the medians along San Marin and San Andreas Drives were originally landscaped with lawns and some non-native plants. The 1975-1977 drought temporarily curtailed watering and much of the landscaping declined or died. Funds for replanting were difficult to obtain as a result of Proposition 13, which was enacted by the California electorate in 1978.

A plan for the re-landscaping evolved wherein the City funded the \$180,000 project and the San Marin Homeowners agreed to a special assessment district to fund the ongoing maintenance and for the repairs of landscaping within the District.

COMPLIANCE WITH THE CALIFORNIA CONSTITUTION

Assessments are levied annually pursuant to the Landscape and Lighting Act of 1972, Part 2 of Division 15 of the California Streets and Highways Code ("1972 Act"). All assessments described in this Report and approved by the City Council are prepared in accordance with the 1972 Act and are in compliance with the provisions of the California Constitution Article XIID ("Article XIID"), which was enacted with the passage of Proposition 218 ("Prop 218") in November 1996.

In accordance with the requirements of Prop 218, on July 8, 1997, the property owners approved a formula for increasing assessments in succeeding years that allows the maintenance cost to increase according to the San Francisco/Oakland/Hayward Consumer Price Index for all Urban Consumers (CPI-U).

Any future increase in the assessment rate, beyond the annual CPI-U adjustment, or substantial changes in the services provided that would cause an assessment increase would require that the District be brought into compliance with all of the requirements of Article XIID and would require the approval of the property owners per Prop 218.

SUMMARY OF PROPOSED ASSESSMENT AND EXPENDITURES

A summary of the assessments to be levied is shown in the table below.

Property Type	Rate per EDU	Basis
Multiple Property Types	\$42.44	Equivalent Dwelling Unit (EDU)



PART II – PLANS AND SPECIFICATIONS

Plans and Specifications

LEVEL OF MAINTENANCE SERVICES PROVIDED

The costs for providing for the landscape maintenance program are divided into the following categories:

- 1) Contract Services for Routine Landscape Maintenance, including SMIA management fee
- 2) Irrigation Maintenance and Plant Replacements
- 3) Allocated Salaries for District Administration
- 4) Water & Electricity
- 5) Administrative Services
- 6) A County of Marin Fee to collect the assessments

As generally defined in the 1972 Act, maintenance and servicing of the improvements may include one or any combination of the following:

- 1) The installation or planting of landscaping.
- 2) The installation or construction of statuary, fountains, and other ornamental structures and facilities.
- 3) The installation or construction of public lighting facilities, including, but not limited to streetlights and traffic signals.
- 4) The installation or construction of any facilities which are appurtenant to any of the foregoing or which are necessary or convenient for the maintenance or servicing thereof; including but not limited to, grading, removal of debris, the installation or construction of curbs, gutters, walls, sidewalks, or paving, or water, irrigation, drainage, or electrical facilities.
- 5) The installation of park or recreational improvements including, but not limited to the following:
 - a) Land preparation, such as grading, leveling, cutting and filling, sod, landscaping, irrigation systems, sidewalks, and drainage; and,
 - b) Lights, playground equipment, play courts and public restrooms.
- 6) The maintenance or servicing, or both, of any of the foregoing including the furnishing of services and materials for the ordinary and usual maintenance, operation, and servicing of any improvement, including, but not limited to:
 - a) Repair, removal, or replacement of all or any part of any improvements;
 - b) Grading, clearing, removal of debris, the installation, repair or construction of curbs, gutters, walls, sidewalks, or paving, or water, irrigation, drainage, or electrical facilities;
 - c) Providing for the life, growth, health, and beauty of landscaping, including cultivation, irrigation, trimming, spraying, fertilizing, or treating for disease or injury;
 - d) The removal of trimmings, rubbish, debris, and other solid waste;
 - e) The cleaning, sandblasting, and painting of walls and other improvements to remove or cover graffiti;



- f) Electric current or energy, gas, or other agent for the lighting or operation of any other improvements; and,
 - g) Water for the irrigation of any landscaping, the operation of any fountains, or the maintenance of any other improvements.
- 7) The acquisition of land for park, recreational or open-space purposes, or the acquisition of any existing improvement otherwise authorized by the 1972 Act.
- 8) Incidental expenses associated with the improvements including, but not limited to:
- a) The cost of preparation of the report, including plans, specifications, estimates, diagram, and assessment;
 - b) The costs of printing, advertising, and the publishing, posting and mailing of notices;
 - c) Compensation payable to the County for collection of assessments;
 - d) Compensation of any engineer or attorney employed to render services;
 - e) Any other expenses incidental to the construction, installation, or maintenance and servicing of the improvements; and,
 - f) Costs associated with any assessment balloting held for the approval of a new or increased assessment.

Pursuant to the 1972 Act:

"Maintain" or "maintenance" means the furnishing of services and materials for the ordinary and usual maintenance, operation, and servicing of any improvement, including repair, removal, or replacement of all or any part of any improvement.

"Service" or "servicing" means the furnishing of electric current or energy, gas, or other illuminating agent for any public lighting facilities or for the lighting or operation of any other improvements.

The landscaping improvements are contained within public median islands along San Marin and San Andreas Drive, and other miscellaneous areas in the San Marin area. The specific areas being maintained by this District are also shown on the diagrams in Appendix B of this Report.



PART III – COST ESTIMATE

Cost Estimate

**San Marin Landscape Assessment District A-81
 Proposed Budget-Fiscal Year 2021/22**

Proposed Expenditures FY 2021/22

Maintenance and Operations	\$29,509
Median Improvements (Landscaping-Irrigation)	\$20,000
SMIA Management Services Contract	\$1,800
Water	\$14,840
Electricity	\$606
Admin Services ¹	\$3,600
Collection Fees (County of Marin)	<u>\$3,234</u>
Subtotal Proposed Expenditures FY 2021/22	\$73,589
Projected Carryover Fund Balance 2020/21	\$64,907
Fund surplus	-\$8,682
Fund Balance*	\$58,582
Proposed Assessment for FY 2021/22	\$67,265
No. of Assessment Units	1,584.81
2021/22 Assessment per Unit:	\$42.44
(Maximum allowable unit assessment):	\$42.44

*Pursuant to Section 22569 of the California Streets and Highways Code, a reserve may be included in the district budget. The reserve includes funding for future capital improvements.

¹ Finance staff, admin support, legal noticing fees and Harris & Assoc. annual fee.

In June 1983, the City, by contract with the San Marin Improvement Association (SMIA), delegated to the SMIA, the management of the maintenance services for the District's improvements. The City retained the administration and legal responsibilities. The agreement self-renews annually so long as the SMIA satisfactorily fulfills its duties as prescribed in the contract with the City of Novato.

All improvements within the District are maintained and serviced on a regular basis. Based upon the available revenues generated by the assessment, SMIA representatives determine the frequency and specific maintenance operations which can be provided in a given year. The expenditures for this fiscal year include the routine maintenance of the existing landscaping on San Marin and San Andreas Drive, additional replacement of landscaping that has reached the end of its useful life, and extraordinary landscape/tree trimming.



The responsibilities of the City and SMIA pursuant to the agreement are summarized below:

City	SMIA
Inspect periodically	Employ contractor(s) to perform all maintenance and repairs per guidelines of the agreement
Pay water and power expenses directly to the utility companies	Communicate as to maintenance work directly with the residents and property owners
Levy annual assessments	Submit draft budget and work plan to the City by 2/28 annually
Administer the assessment district and the financial aspects of the work	Submit monthly itemized billing to the City
Summarize accounting reports annually	

The proposed budget is shown on the following page. This includes an estimate of the costs of utilities, operations, services, administration and maintenance associated with the improvements within the district, including all labor, personnel, equipment, materials and administrative expenses. The budget summary also shows the estimated fund balance and the projected fund reserves that will be available and may be required based upon the estimated expenditures and assessment revenue.



Financial Summary FY 2020-21

San Marin Landscape Assessment District A-81 Financial Summary-Fiscal Year 2020-21

Projected Revenue in FY 2020/21:

Carryover from 2019/20	\$60,457
2020/21 Assessments (less collection fee) ¹	\$62,977
Investment Earnings Projected through 6/30/2021	<u>\$500</u>
Total Projected Revenue through 6/30/2021:	\$123,934

Projected Expenditures in FY 2020/21:

Admin Services ²	\$2,900
SMIA Management Services	\$1,800
Regular Maintenance and Operation (Contract)	\$29,016
Additional Irrigation Repair/Landscape Renewal	\$7,500
Allocated Salaries ³	\$0
County Collection Fee	\$3,234
Electricity	\$577
Water	<u>\$14,000</u>
Total Projected Expenditures through 6/30/2021:	\$59,027

Projected Carryover Fund Balance as of 6/30/2021: \$64,907

¹Projected includes 2nd Installment

²Finance staff, admin support, legal noticing and Harris Assoc annual fee (\$2900)

³Engineering staff hours worked on this project times the hourly billing rate for Novato's cost recovery system



PART IV – METHOD OF APPORTIONMENT

Method of Apportionment

GENERAL PROVISIONS

The 1972 Act permits the establishment of assessment districts by agencies for the purpose of providing certain public improvements which include the construction, maintenance and servicing of public lights, landscaping and appurtenant facilities. The 1972 Act further requires that the cost of these improvements be levied according to benefit rather than assessed value:

“The net amount to be assessed upon lands within an assessment district may be apportioned by any formula or method which fairly distributes the net amount among all assessable lots or parcels in proportion to the estimated benefits to be received by each such lot or parcel from the improvements.”

The formula used for calculating assessments in the District therefore reflects the composition of the parcels, and the improvements and services provided, to fairly apportion the costs based on estimated benefit to each parcel. In addition, pursuant to Prop 218:

“No assessment shall be imposed on any parcel which exceeds the reasonable cost of the proportional special benefit conferred on that parcel. Only special benefits are assessable and an agency shall separate the general benefits from the special benefits.”

BENEFIT ANALYSIS

Each of the improvements have been carefully reviewed by the City and the corresponding assessments have been proportionately spread to each parcel based on improvements as determined at the time the District was established, and later affirmed in a Prop 218 balloting conducted July 8, 1997.

General Benefits

The improvements within this District are a direct result of property development within the District and would otherwise not be required or necessary. Developers typically install landscape improvements to enhance the marketability and value of properties within the development and/or as conditions of development. In either case, the improvements are clearly installed for the benefit of the properties developed and not for the benefit of surrounding properties.

Although many landscape improvements (by virtue of location), may be visible to surrounding properties or to the public at large, any benefit to surrounding properties is incidental and cannot be considered a direct and special benefit to those properties. Therefore, it has been determined that the improvements within this District and the ongoing operation and maintenance of those improvements are clearly a direct and special benefit to properties within the District. Unless otherwise noted, these improvements provide no measurable benefit to properties outside the District or to the public at large.



Special Benefits

The method of apportionment (assessment methodology) approved at the time the District was formed is based on the premise that each of the assessed parcels within the District receives benefit from the improvements maintained and financed by annual assessments. Specifically, the assessments are for the maintenance of local landscape improvements installed as part of the original improvement. The desirability and safety of properties within the District are enhanced by the presence of well-maintained landscaping. The special benefits associated with the local landscaping improvements are specifically:

- Enhanced desirability of properties through association with the improvements.
- Improved aesthetic appeal of properties within the District providing a positive representation of the area.
- Enhanced adaptation of the urban environment within the natural environment from adequate green space and landscaping.
- Increased sense of pride in ownership of property within the District resulting from well-maintained improvements associated with the properties.

All of the preceding special benefits contribute to a specific enhancement and desirability of each of the assessed parcels within the District.

Non-Assessable Parcels

Within the boundaries of the District, there are several types of properties that are considered to receive no special benefit from the District improvements and are therefore not assessed. These parcels may include:

- 1) Publicly owned parcels that are reserved as Public Open Space or are developed as City Parks for active recreation and are maintained and serviced by the District;
- 2) Publicly owned wetland parcels;
- 3) Certain Public Utility parcels;
- 4) Privately owned open space parcels; and
- 5) Privately owned "sliver" parcels that have resulted from a lot line adjustment with an adjacent larger parcel



ASSESSMENT METHODOLOGY

The Engineer's Report for the 1997 Proposition 218 election included a very detailed evaluation of the method of apportionment (assessment spread) for this district and is quite lengthy in its discussion and analysis of the assessment methodology. The current method of apportionment is essentially the same as the one adopted at the creation of the district in 1983. The information from the 1983 report is incorporated herein for reference, and is filed at the Engineering Division of the Public Works Department. Assessable parcels are assigned an Equivalent Dwelling Unit (EDU) measure based upon multiple factors including land use and proximity to the improvements. The EDU total for each assessable parcel is multiplied by the assessment rate per EDU with the resulting product being the parcel's annual assessment amount for the fiscal year. A district summary of this methodology is shown below, along with the quantification of the district maximum assessment rate.

Proposed Assessment for FY 2021/22	\$67,264.68
No. of Assessment Units	1,584.81
2021/22 Assessment per Unit:	\$42.44
<i>**Variance due to rounding</i>	
(Maximum Allowable Unit Assessment):	\$42.44

APPENDIX A – PROPOSITION 218 COMPLIANCE RECORD

Proposition 218 Compliance Record

San Marin Landscaping District A-81
 Proposition 218 Compliance Record

Prop 218 Assessment Balloting- Approved Maximum Assessment Amount and CPI Inflation and Adjustment
 SF/Oakland/Hayward (CPI-U) US Department of Labor and Statistics

Date of Assessment Balloting: July 8, 1997
 Maximum Unit Assessment: \$22.50

Maximum Assessment Adjustments

Fiscal Year	Prior FY Max. Unit Assessment	Previous FY Index - Feb	Current FY Index -Feb	Inflation Adjustment	Total Maximum Assessment	Actual Unit Assessment
98/99	\$22.5000	n/a	n/a	n/a	\$22.5000	\$22.50
99/00	\$22.5000	164.6	172.2	4.6173%	\$23.5389	\$23.54
00/01	\$23.5389	172.2	178.6	3.7166%	\$24.4137	\$24.41
01/02	\$24.4137	178.6	189.1	5.8791%	\$25.8490	\$25.85
02/03	\$25.8490	189.1	193.0	2.0624%	\$26.3821	\$26.38
03/04	\$26.3821	193.0	197.3	2.2280%	\$26.9699	\$26.97
04/05	\$26.9699	197.3	198.1	0.4055%	\$27.0793	\$27.08
05/06	\$27.0793	187.4	193.3	3.1483%	\$27.9318	\$27.93
06/07	\$27.9318	193.3	199.8	3.3626%	\$28.8711	\$28.87
07/08	\$28.8711	199.8	206.2	3.2032%	\$29.7959	\$29.80
08/09	\$29.7959	213.7	219.6	2.7723%	\$30.6219	\$30.62
09/10	\$30.6219	219.6	222.2	1.1630%	\$30.9780	\$30.98
10/11	\$30.9780	222.2	226.1	1.7910%	\$31.5328	\$31.53
11/12	\$31.5328	226.1	230.0	1.6963%	\$32.0677	\$32.07
12/13	\$32.0677	230.0	236.9	2.9998%	\$33.0297	\$33.02
13/14	\$33.0297	236.9	242.7	2.4472%	\$33.8380	\$33.82
14/15	\$33.8380	242.7	248.6	2.4469%	\$34.6660	\$34.64
15/16	\$34.6660	248.6	254.9	2.5320%	\$35.5437	\$35.52
16/17	\$35.5437	254.9	262.6	3.0168%	\$36.6160	\$36.60
17/18	\$36.6160	262.6	271.6	3.4372%	\$37.8745	\$37.86
18/19	\$37.8745	271.6	281.3	3.5645%	\$39.2246	\$39.00
19/20	\$39.2246	281.3	291.2	3.5260%	\$40.6076	\$40.60
20/21	\$40.6076	291.2	299.7	2.9060%	\$41.7877	\$41.78
21/22	\$41.7877	299.7	304.4	1.5673%	\$42.4426	\$42.44

APPENDIX B – DISTRICT DIAGRAM

District Diagram

The following pages show the District Diagram and the landscaped median improvement map.



SAN MARIN LANDSCAPE ASSESSMENT DISTRICT A-81

SAN MARIN LANDSCAPED MEDIAN ISLANDS

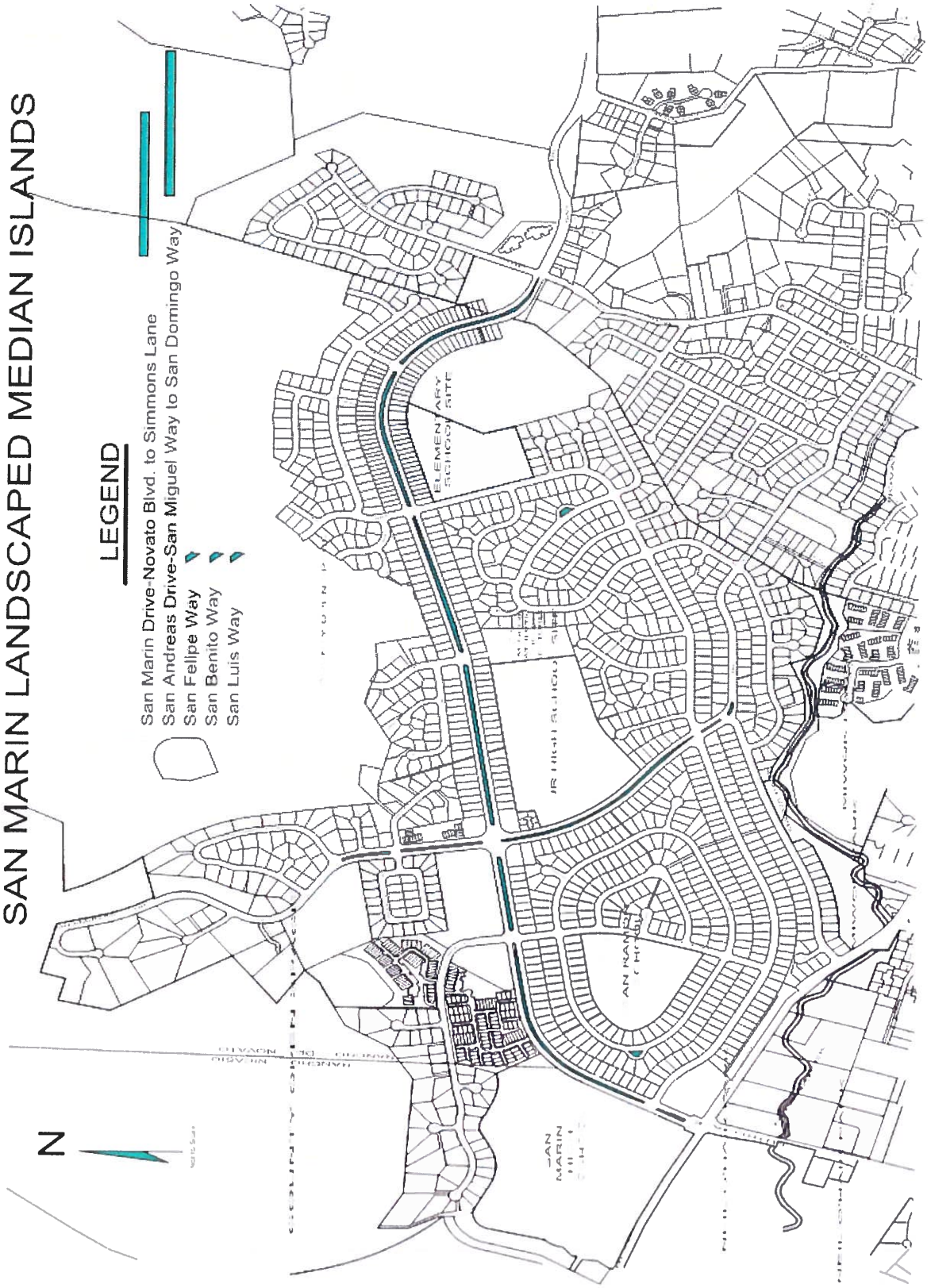



APPENDIX C – ASSESSMENT ROLL

Assessment Roll

The proposed assessment and the amount of the assessment apportioned to each lot or parcel, as shown on the latest roll at the Assessor's Office, is shown on the following pages. The description of each lot or parcel is part of the records of the Assessor of the County of Marin and those records are, by reference, made part of this report. The assessments shown will be submitted to the County Auditor/Controller, and included on the property tax bill for each parcel shown in the assessment roll for Fiscal Year 2021-22.

APN	Land Use	EDU	Assessment Rate	Assessment
124-010-08	TAX EXEMPTS	0	\$42.44	\$0.00
124-010-09	TAX EXEMPTS	0	\$42.44	\$0.00
124-020-04	TAX EXEMPTS	0	\$42.44	\$0.00
124-020-07	TAX EXEMPTS	0	\$42.44	\$0.00
124-020-11	MISCELLANEOUS	0	\$42.44	\$0.00
124-020-23	RESIDENTIAL	0	\$42.44	\$0.00
124-020-24	TAX EXEMPTS	0	\$42.44	\$0.00
124-030-01	RESID. SINGLE FAMILY	0.9	\$42.44	\$38.20
124-030-02	RESID. SINGLE FAMILY	0.9	\$42.44	\$38.20
124-030-03	RESID. SINGLE FAMILY	0.9	\$42.44	\$38.20
124-030-04	RESID. SINGLE FAMILY	0.9	\$42.44	\$38.20
124-030-05	RESID. SINGLE FAMILY	0.9	\$42.44	\$38.20
124-030-06	RESID. SINGLE FAMILY	0.9	\$42.44	\$38.20
124-030-07	RESID. SINGLE FAMILY	0.9	\$42.44	\$38.20
124-030-08	RESID. SINGLE FAMILY	0.9	\$42.44	\$38.20
124-030-09	RESID. SINGLE FAMILY	0.9	\$42.44	\$38.20
124-030-10	RESID. SINGLE FAMILY	0.9	\$42.44	\$38.20
124-030-11	RESID. SINGLE FAMILY	0.9	\$42.44	\$38.20
124-030-12	RESID. SINGLE FAMILY	0.9	\$42.44	\$38.20
124-030-13	RESID. SINGLE FAMILY	0.9	\$42.44	\$38.20
124-030-14	RESID. SINGLE FAMILY	0.9	\$42.44	\$38.20
124-030-15	RESID. SINGLE FAMILY	0.9	\$42.44	\$38.20
124-030-16	RESID. SINGLE FAMILY	0.9	\$42.44	\$38.20
124-030-17	RESID. SINGLE FAMILY	0.9	\$42.44	\$38.20
124-030-18	RESID. SINGLE FAMILY	0.9	\$42.44	\$38.20
124-030-19	RESID. SINGLE FAMILY	0.9	\$42.44	\$38.20
124-030-20	RESID. SINGLE FAMILY	0.9	\$42.44	\$38.20
124-030-21	RESID. SINGLE FAMILY	0.9	\$42.44	\$38.20
124-030-22	RESID. SINGLE FAMILY	0.9	\$42.44	\$38.20
124-030-23	RESID. SINGLE FAMILY	0.9	\$42.44	\$38.20



APN	Land Use	EDU	Assessment Rate	Assessment
124-030-24	RESID. SINGLE FAMILY	0.9	\$42.44	\$38.20
124-030-25	RESID. SINGLE FAMILY	0.9	\$42.44	\$38.20
124-030-26	RESID. SINGLE FAMILY	0.9	\$42.44	\$38.20
124-030-27	RESID. SINGLE FAMILY	0.9	\$42.44	\$38.20
124-030-28	TAX EXEMPTS	0	\$42.44	\$0.00
124-030-29	RESID. SINGLE FAMILY	0.9	\$42.44	\$38.20
124-030-30	RESID. SINGLE FAMILY	0.9	\$42.44	\$38.20
124-030-31	RESID. SINGLE FAMILY	0.9	\$42.44	\$38.20
124-030-32	RESID. SINGLE FAMILY	0.9	\$42.44	\$38.20
124-030-33	RESID. SINGLE FAMILY	0.9	\$42.44	\$38.20
124-030-34	RESID. SINGLE FAMILY	0.9	\$42.44	\$38.20
124-030-35	RESID. SINGLE FAMILY	0.9	\$42.44	\$38.20
124-030-36	RESID. SINGLE FAMILY	0.9	\$42.44	\$38.20
124-030-37	RESID. SINGLE FAMILY	0.9	\$42.44	\$38.20
124-030-38	RESID. SINGLE FAMILY	0.9	\$42.44	\$38.20
124-030-39	RESID. SINGLE FAMILY	0.9	\$42.44	\$38.20
124-030-40	RESID. SINGLE FAMILY	0.9	\$42.44	\$38.20
124-030-41	RESID. SINGLE FAMILY	0.9	\$42.44	\$38.20
124-030-42	RESID. SINGLE FAMILY	0.9	\$42.44	\$38.20
124-030-43	RESID. SINGLE FAMILY	0.9	\$42.44	\$38.20
124-030-44	RESID. SINGLE FAMILY	0.9	\$42.44	\$38.20
124-030-45	RESID. SINGLE FAMILY	0.9	\$42.44	\$38.20
124-030-46	RESID. SINGLE FAMILY	0.9	\$42.44	\$38.20
124-030-47	RESID. SINGLE FAMILY	0.9	\$42.44	\$38.20
124-030-48	RESID. SINGLE FAMILY	0.9	\$42.44	\$38.20
124-030-49	RESID. SINGLE FAMILY	0.9	\$42.44	\$38.20
124-030-50	RESID. SINGLE FAMILY	0.9	\$42.44	\$38.20
124-030-51	RESID. SINGLE FAMILY	0.9	\$42.44	\$38.20
124-030-52	RESID. SINGLE FAMILY	0.9	\$42.44	\$38.20
124-030-53	RESID. SINGLE FAMILY	0.9	\$42.44	\$38.20
124-030-63	RESID. SINGLE FAMILY	0.9	\$42.44	\$38.20
124-030-64	TAX EXEMPTS	0	\$42.44	\$0.00
124-030-65	RESID. SINGLE FAMILY	0.9	\$42.44	\$38.20
124-030-66	RESID. SINGLE FAMILY	0.9	\$42.44	\$38.20
124-030-67	RESID. SINGLE FAMILY	0.9	\$42.44	\$38.20
124-030-68	RESID. SINGLE FAMILY	0.9	\$42.44	\$38.20
124-030-69	RESID. SINGLE FAMILY	0.9	\$42.44	\$38.20
124-030-70	RESID. SINGLE FAMILY	0.9	\$42.44	\$38.20
124-030-71	RESID. SINGLE FAMILY	0.9	\$42.44	\$38.20
124-030-72	RESID. SINGLE FAMILY	1	\$42.44	\$42.44
124-030-73	RESID. SINGLE FAMILY	1	\$42.44	\$42.44



APN	Land Use	EDU	Assessment Rate	Assessment
124-030-74	RESID. SINGLE FAMILY	1	\$42.44	\$42.44
124-030-75	RESID. SINGLE FAMILY	1	\$42.44	\$42.44
124-030-76	RESID. SINGLE FAMILY	1	\$42.44	\$42.44
124-030-77	RESID. SINGLE FAMILY	1	\$42.44	\$42.44
124-030-78	RESID. SINGLE FAMILY	1	\$42.44	\$42.44
124-030-87	RESID. SINGLE FAMILY	0.9	\$42.44	\$38.20
124-030-88	RESID. SINGLE FAMILY	0.9	\$42.44	\$38.20
124-030-89	RESID. SINGLE FAMILY	0.9	\$42.44	\$38.20
124-030-90	RESID. SINGLE FAMILY	0.9	\$42.44	\$38.20
124-030-91	RESID. SINGLE FAMILY	0.9	\$42.44	\$38.20
124-030-92	RESID. SINGLE FAMILY	0.9	\$42.44	\$38.20
124-030-93	RESID. SINGLE FAMILY	0.9	\$42.44	\$38.20
124-030-94	RESID. SINGLE FAMILY	0.9	\$42.44	\$38.20
124-041-01	RESID. SINGLE FAMILY	0.9	\$42.44	\$38.20
124-041-02	RESID. SINGLE FAMILY	0.9	\$42.44	\$38.20
124-042-01	RESID. SINGLE FAMILY	0.9	\$42.44	\$38.20
124-042-02	RESID. SINGLE FAMILY	0.9	\$42.44	\$38.20
124-042-03	RESID. SINGLE FAMILY	0.9	\$42.44	\$38.20
124-042-04	RESID. SINGLE FAMILY	0.9	\$42.44	\$38.20
124-042-05	RESID. SINGLE FAMILY	0.9	\$42.44	\$38.20
124-042-06	RESID. SINGLE FAMILY	0.9	\$42.44	\$38.20
124-042-07	RESID. SINGLE FAMILY	0.9	\$42.44	\$38.20
124-042-08	RESID. SINGLE FAMILY	0.9	\$42.44	\$38.20
124-042-09	RESID. SINGLE FAMILY	0.9	\$42.44	\$38.20
124-042-10	RESID. SINGLE FAMILY	0.9	\$42.44	\$38.20
124-042-11	TAX EXEMPTS	0.9	\$42.44	\$38.20
124-042-12	RESID. SINGLE FAMILY	0.9	\$42.44	\$38.20
124-042-13	RESID. SINGLE FAMILY	0.9	\$42.44	\$38.20
124-042-14	RESID. SINGLE FAMILY	0.9	\$42.44	\$38.20
124-042-15	RESID. SINGLE FAMILY	1	\$42.44	\$42.44
124-042-16	RESID. SINGLE FAMILY	1	\$42.44	\$42.44
124-042-17	RESID. SINGLE FAMILY	1	\$42.44	\$42.44
124-042-18	RESID. SINGLE FAMILY	1	\$42.44	\$42.44
124-042-19	RESID. SINGLE FAMILY	1	\$42.44	\$42.44
124-042-20	RESID. SINGLE FAMILY	0.9	\$42.44	\$38.20
124-042-21	RESID. SINGLE FAMILY	0.9	\$42.44	\$38.20
124-042-22	RESID. SINGLE FAMILY	0.9	\$42.44	\$38.20
124-042-23	RESID. SINGLE FAMILY	0.9	\$42.44	\$38.20
124-042-24	RESID. SINGLE FAMILY	0.9	\$42.44	\$38.20
124-043-01	RESID. SINGLE FAMILY	0.9	\$42.44	\$38.20
124-043-02	TAX EXEMPTS	0.9	\$42.44	\$38.20



APN	Land Use	EDU	Assessment Rate	Assessment
124-043-03	RESID. SINGLE FAMILY	0.9	\$42.44	\$38.20
124-043-04	RESID. SINGLE FAMILY	0.9	\$42.44	\$38.20
124-043-05	RESID. SINGLE FAMILY	0.9	\$42.44	\$38.20
124-043-06	RESID. SINGLE FAMILY	0.9	\$42.44	\$38.20
124-043-07	RESID. SINGLE FAMILY	0.9	\$42.44	\$38.20
124-043-08	RESID. SINGLE FAMILY	0.9	\$42.44	\$38.20
124-043-09	RESID. SINGLE FAMILY	0.9	\$42.44	\$38.20
124-043-10	TAX EXEMPTS	0.9	\$42.44	\$38.20
124-043-11	RESID. SINGLE FAMILY	0.9	\$42.44	\$38.20
124-043-12	RESID. SINGLE FAMILY	0.9	\$42.44	\$38.20
124-043-13	RESID. SINGLE FAMILY	0.9	\$42.44	\$38.20
124-043-14	RESID. SINGLE FAMILY	0.9	\$42.44	\$38.20
124-043-15	RESID. SINGLE FAMILY	0.9	\$42.44	\$38.20
124-043-16	RESID. SINGLE FAMILY	0.9	\$42.44	\$38.20
124-043-17	RESID. SINGLE FAMILY	0.9	\$42.44	\$38.20
124-043-18	RESID. SINGLE FAMILY	0.9	\$42.44	\$38.20
124-043-19	RESID. SINGLE FAMILY	0.9	\$42.44	\$38.20
124-043-20	RESID. SINGLE FAMILY	0.9	\$42.44	\$38.20
124-044-01	RESID. SINGLE FAMILY	0.9	\$42.44	\$38.20
124-044-02	RESID. SINGLE FAMILY	0.9	\$42.44	\$38.20
124-044-03	RESID. SINGLE FAMILY	0.9	\$42.44	\$38.20
124-044-04	RESID. SINGLE FAMILY	0.9	\$42.44	\$38.20
124-044-05	RESID. SINGLE FAMILY	0.9	\$42.44	\$38.20
124-044-06	RESID. SINGLE FAMILY	0.9	\$42.44	\$38.20
124-044-07	RESID. SINGLE FAMILY	0.9	\$42.44	\$38.20
124-044-08	RESID. SINGLE FAMILY	0.9	\$42.44	\$38.20
124-044-09	RESID. SINGLE FAMILY	0.9	\$42.44	\$38.20
124-044-10	RESID. SINGLE FAMILY	0.9	\$42.44	\$38.20
124-044-11	RESID. SINGLE FAMILY	0.9	\$42.44	\$38.20
124-044-12	RESID. SINGLE FAMILY	0.9	\$42.44	\$38.20
124-044-13	RESID. SINGLE FAMILY	0.9	\$42.44	\$38.20
124-044-14	RESID. SINGLE FAMILY	0.9	\$42.44	\$38.20
124-044-15	RESID. SINGLE FAMILY	0.9	\$42.44	\$38.20
124-044-16	RESID. SINGLE FAMILY	0.9	\$42.44	\$38.20
124-044-17	RESID. SINGLE FAMILY	0.9	\$42.44	\$38.20
124-044-18	RESID. SINGLE FAMILY	0.9	\$42.44	\$38.20
124-044-19	RESID. SINGLE FAMILY	0.9	\$42.44	\$38.20
124-044-20	RESID. SINGLE FAMILY	0.9	\$42.44	\$38.20
124-044-21	RESID. SINGLE FAMILY	0.9	\$42.44	\$38.20
124-044-22	RESID. SINGLE FAMILY	0.9	\$42.44	\$38.20
124-044-23	RESID. SINGLE FAMILY	0.9	\$42.44	\$38.20



APN	Land Use	EDU	Assessment Rate	Assessment
124-044-24	RESID. SINGLE FAMILY	0.9	\$42.44	\$38.20
124-045-01	RESID. SINGLE FAMILY	0.9	\$42.44	\$38.20
124-045-02	RESID. SINGLE FAMILY	0.9	\$42.44	\$38.20
124-045-03	RESID. SINGLE FAMILY	0.9	\$42.44	\$38.20
124-045-04	RESID. SINGLE FAMILY	0.9	\$42.44	\$38.20
124-045-05	RESID. SINGLE FAMILY	0.9	\$42.44	\$38.20
124-045-06	RESID. SINGLE FAMILY	0.9	\$42.44	\$38.20
124-045-07	RESID. SINGLE FAMILY	0.9	\$42.44	\$38.20
124-045-08	RESID. SINGLE FAMILY	0.9	\$42.44	\$38.20
124-045-09	RESID. SINGLE FAMILY	0.9	\$42.44	\$38.20
124-045-10	RESID. SINGLE FAMILY	0.9	\$42.44	\$38.20
124-045-11	RESID. SINGLE FAMILY	0.9	\$42.44	\$38.20
124-045-12	RESID. SINGLE FAMILY	0.9	\$42.44	\$38.20
124-045-13	RESID. SINGLE FAMILY	0.9	\$42.44	\$38.20
124-045-14	RESID. SINGLE FAMILY	0.9	\$42.44	\$38.20
124-045-15	RESID. SINGLE FAMILY	0.9	\$42.44	\$38.20
124-045-16	RESID. SINGLE FAMILY	0.9	\$42.44	\$38.20
124-045-17	RESID. SINGLE FAMILY	0.9	\$42.44	\$38.20
124-045-18	RESID. SINGLE FAMILY	0.9	\$42.44	\$38.20
124-045-19	RESID. SINGLE FAMILY	0.9	\$42.44	\$38.20
124-045-20	RESID. SINGLE FAMILY	0.9	\$42.44	\$38.20
124-045-21	RESID. SINGLE FAMILY	0.9	\$42.44	\$38.20
124-045-22	RESID. SINGLE FAMILY	0.9	\$42.44	\$38.20
124-060-01	RESID. SINGLE FAMILY	0.9	\$42.44	\$38.20
124-060-02	RESID. SINGLE FAMILY	0.9	\$42.44	\$38.20
124-060-03	RESID. SINGLE FAMILY	0.9	\$42.44	\$38.20
124-060-04	RESID. SINGLE FAMILY	0.9	\$42.44	\$38.20
124-060-05	RESID. SINGLE FAMILY	0.9	\$42.44	\$38.20
124-060-06	RESID. SINGLE FAMILY	0.9	\$42.44	\$38.20
124-060-07	RESID. SINGLE FAMILY	0.9	\$42.44	\$38.20
124-060-08	RESID. SINGLE FAMILY	0.9	\$42.44	\$38.20
124-060-09	RESID. SINGLE FAMILY	0.9	\$42.44	\$38.20
124-060-10	RESID. SINGLE FAMILY	0.9	\$42.44	\$38.20
124-060-11	RESID. SINGLE FAMILY	0.9	\$42.44	\$38.20
124-060-12	RESID. SINGLE FAMILY	0.9	\$42.44	\$38.20
124-060-13	RESID. SINGLE FAMILY	0.9	\$42.44	\$38.20
124-060-14	RESID. SINGLE FAMILY	0.9	\$42.44	\$38.20
124-060-19	RESID. SINGLE FAMILY	0.9	\$42.44	\$38.20
124-060-22	RESID. SINGLE FAMILY	0.9	\$42.44	\$38.20
124-071-01	RESID. SINGLE FAMILY	0.9	\$42.44	\$38.20
124-071-02	RESID. SINGLE FAMILY	0.9	\$42.44	\$38.20



APN	Land Use	EDU	Assessment Rate	Assessment
124-071-03	RESID. SINGLE FAMILY	0.9	\$42.44	\$38.20
124-071-04	RESID. SINGLE FAMILY	0.9	\$42.44	\$38.20
124-071-05	RESID. SINGLE FAMILY	0.9	\$42.44	\$38.20
124-071-07	RESID. SINGLE FAMILY	0.9	\$42.44	\$38.20
124-071-08	RESID. SINGLE FAMILY	0.9	\$42.44	\$38.20
124-071-09	RESID. SINGLE FAMILY	0.9	\$42.44	\$38.20
124-071-10	RESID. SINGLE FAMILY	0.9	\$42.44	\$38.20
124-071-11	RESID. SINGLE FAMILY	0.9	\$42.44	\$38.20
124-071-12	RESID. SINGLE FAMILY	0.9	\$42.44	\$38.20
124-071-13	RESID. SINGLE FAMILY	0.9	\$42.44	\$38.20
124-071-14	RESID. SINGLE FAMILY	0.9	\$42.44	\$38.20
124-071-15	RESID. SINGLE FAMILY	0.9	\$42.44	\$38.20
124-071-16	RESID. SINGLE FAMILY	0.9	\$42.44	\$38.20
124-071-17	RESID. SINGLE FAMILY	0.9	\$42.44	\$38.20
124-071-18	RESID. SINGLE FAMILY	0.9	\$42.44	\$38.20
124-071-19	RESID. SINGLE FAMILY	0.9	\$42.44	\$38.20
124-071-20	RESID. SINGLE FAMILY	0.9	\$42.44	\$38.20
124-071-21	RESID. SINGLE FAMILY	0.9	\$42.44	\$38.20
124-071-22	RESID. SINGLE FAMILY	0.9	\$42.44	\$38.20
124-071-23	RESID. SINGLE FAMILY	0.9	\$42.44	\$38.20
124-071-24	RESID. SINGLE FAMILY	0.9	\$42.44	\$38.20
124-071-25	RESID. SINGLE FAMILY	0.9	\$42.44	\$38.20
124-071-26	RESID. SINGLE FAMILY	0.9	\$42.44	\$38.20
124-071-27	RESID. SINGLE FAMILY	0.9	\$42.44	\$38.20
124-071-28	RESID. SINGLE FAMILY	0.9	\$42.44	\$38.20
124-071-29	RESID. SINGLE FAMILY	0.9	\$42.44	\$38.20
124-071-30	RESID. SINGLE FAMILY	0.9	\$42.44	\$38.20
124-071-31	RESID. SINGLE FAMILY	0.9	\$42.44	\$38.20
124-071-32	RESID. SINGLE FAMILY	0.9	\$42.44	\$38.20
124-071-33	RESID. SINGLE FAMILY	0.9	\$42.44	\$38.20
124-071-34	RESID. SINGLE FAMILY	0.9	\$42.44	\$38.20
124-071-35	RESID. SINGLE FAMILY	0.9	\$42.44	\$38.20
124-071-36	RESID. SINGLE FAMILY	0.9	\$42.44	\$38.20
124-071-37	RESID. SINGLE FAMILY	0.9	\$42.44	\$38.20
124-071-38	RESID. SINGLE FAMILY	0.9	\$42.44	\$38.20
124-071-39	RESID. SINGLE FAMILY	0.9	\$42.44	\$38.20
124-071-40	RESID. SINGLE FAMILY	0.9	\$42.44	\$38.20
124-071-41	RESID. SINGLE FAMILY	0.9	\$42.44	\$38.20
124-071-42	RESID. SINGLE FAMILY	0.9	\$42.44	\$38.20
124-071-43	RESID. SINGLE FAMILY	0.9	\$42.44	\$38.20
124-071-44	RESID. SINGLE FAMILY	0.9	\$42.44	\$38.20

APN	Land Use	EDU	Assessment Rate	Assessment
124-071-45	RESID. SINGLE FAMILY	0.9	\$42.44	\$38.20
124-071-46	RESID. SINGLE FAMILY	0.9	\$42.44	\$38.20
124-071-47	RESID. SINGLE FAMILY	0.9	\$42.44	\$38.20
124-071-48	RESID. SINGLE FAMILY	0.9	\$42.44	\$38.20
124-071-49	RESID. SINGLE FAMILY	0.9	\$42.44	\$38.20
124-071-50	RESID. SINGLE FAMILY	0.9	\$42.44	\$38.20
124-071-51	RESID. SINGLE FAMILY	0.9	\$42.44	\$38.20
124-071-52	RESID. SINGLE FAMILY	0.9	\$42.44	\$38.20
124-071-53	RESID. SINGLE FAMILY	0.9	\$42.44	\$38.20
124-071-54	RESID. SINGLE FAMILY	0.9	\$42.44	\$38.20
124-071-55	RESID. SINGLE FAMILY	0.9	\$42.44	\$38.20
124-071-56	RESID. SINGLE FAMILY	0.9	\$42.44	\$38.20
124-071-59	RESID. SINGLE FAMILY	0.9	\$42.44	\$38.20
124-081-01	RESID. SINGLE FAMILY	0.9	\$42.44	\$38.20
124-081-02	RESID. SINGLE FAMILY	0.9	\$42.44	\$38.20
124-081-03	RESID. SINGLE FAMILY	0.9	\$42.44	\$38.20
124-081-04	RESID. SINGLE FAMILY	0.9	\$42.44	\$38.20
124-081-05	RESID. SINGLE FAMILY	0.9	\$42.44	\$38.20
124-081-06	RESID. SINGLE FAMILY	0.9	\$42.44	\$38.20
124-081-07	RESID. SINGLE FAMILY	0.9	\$42.44	\$38.20
124-081-08	RESID. SINGLE FAMILY	0.9	\$42.44	\$38.20
124-081-09	RESID. SINGLE FAMILY	0.9	\$42.44	\$38.20
124-081-10	RESID. SINGLE FAMILY	0.9	\$42.44	\$38.20
124-081-11	RESID. SINGLE FAMILY	0.9	\$42.44	\$38.20
124-081-12	RESID. SINGLE FAMILY	0.9	\$42.44	\$38.20
124-081-13	RESID. SINGLE FAMILY	0.9	\$42.44	\$38.20
124-081-14	RESID. SINGLE FAMILY	0.9	\$42.44	\$38.20
124-081-15	RESID. SINGLE FAMILY	0.9	\$42.44	\$38.20
124-081-16	RESID. SINGLE FAMILY	0.9	\$42.44	\$38.20
124-081-17	RESID. SINGLE FAMILY	0.9	\$42.44	\$38.20
124-081-18	RESID. SINGLE FAMILY	0.9	\$42.44	\$38.20
124-081-19	RESID. SINGLE FAMILY	0.9	\$42.44	\$38.20
124-081-20	RESID. SINGLE FAMILY	0.9	\$42.44	\$38.20
124-082-01	RESID. SINGLE FAMILY	0.9	\$42.44	\$38.20
124-082-02	RESID. SINGLE FAMILY	0.9	\$42.44	\$38.20
124-082-03	RESID. SINGLE FAMILY	0.9	\$42.44	\$38.20
124-082-04	RESID. SINGLE FAMILY	0.9	\$42.44	\$38.20
124-082-05	RESID. SINGLE FAMILY	0.9	\$42.44	\$38.20
124-082-06	RESID. SINGLE FAMILY	0.9	\$42.44	\$38.20
124-082-07	RESID. SINGLE FAMILY	0.9	\$42.44	\$38.20
124-082-08	RESID. SINGLE FAMILY	0.9	\$42.44	\$38.20



APN	Land Use	EDU	Assessment Rate	Assessment
124-082-09	RESID. SINGLE FAMILY	0.9	\$42.44	\$38.20
124-082-10	RESID. SINGLE FAMILY	0.9	\$42.44	\$38.20
124-082-11	RESID. SINGLE FAMILY	0.9	\$42.44	\$38.20
124-082-12	RESID. SINGLE FAMILY	0.9	\$42.44	\$38.20
124-082-13	RESID. SINGLE FAMILY	0.9	\$42.44	\$38.20
124-082-14	RESID. SINGLE FAMILY	0.9	\$42.44	\$38.20
124-082-15	RESID. SINGLE FAMILY	0.9	\$42.44	\$38.20
124-082-16	RESID. SINGLE FAMILY	0.9	\$42.44	\$38.20
124-083-01	RESID. SINGLE FAMILY	0.9	\$42.44	\$38.20
124-083-03	RESID. SINGLE FAMILY	0.9	\$42.44	\$38.20
124-083-04	RESID. SINGLE FAMILY	0.9	\$42.44	\$38.20
124-083-05	RESID. SINGLE FAMILY	0.9	\$42.44	\$38.20
124-083-06	RESID. SINGLE FAMILY	0.9	\$42.44	\$38.20
124-083-07	RESID. SINGLE FAMILY	0.9	\$42.44	\$38.20
124-083-08	RESID. SINGLE FAMILY	0.9	\$42.44	\$38.20
124-083-11	RESID. SINGLE FAMILY	0.9	\$42.44	\$38.20
124-083-12	RESID. SINGLE FAMILY	0.9	\$42.44	\$38.20
124-083-13	RESID. SINGLE FAMILY	0.9	\$42.44	\$38.20
124-083-14	RESID. SINGLE FAMILY	0.9	\$42.44	\$38.20
124-083-15	RESID. SINGLE FAMILY	0.9	\$42.44	\$38.20
124-083-16	RESID. SINGLE FAMILY	0.9	\$42.44	\$38.20
124-083-17	RESID. SINGLE FAMILY	0.9	\$42.44	\$38.20
124-083-18	RESID. SINGLE FAMILY	0.9	\$42.44	\$38.20
124-083-19	RESID. SINGLE FAMILY	0.9	\$42.44	\$38.20
124-083-20	RESID. SINGLE FAMILY	0.9	\$42.44	\$38.20
124-083-21	RESID. SINGLE FAMILY	0.9	\$42.44	\$38.20
124-083-22	RESID. SINGLE FAMILY	0.9	\$42.44	\$38.20
124-083-23	RESID. SINGLE FAMILY	0.9	\$42.44	\$38.20
124-083-24	RESID. SINGLE FAMILY	0.9	\$42.44	\$38.20
124-083-25	TAX EXEMPTS	0	\$42.44	\$0.00
124-083-26	RESID. SINGLE FAMILY	0.9	\$42.44	\$38.20
124-083-28	RESID. SINGLE FAMILY	0.9	\$42.44	\$38.20
124-083-29	RESID. SINGLE FAMILY	0.9	\$42.44	\$38.20
124-084-01	RESID. SINGLE FAMILY	0.9	\$42.44	\$38.20
124-084-02	RESID. SINGLE FAMILY	0.9	\$42.44	\$38.20
124-084-03	RESID. SINGLE FAMILY	0.9	\$42.44	\$38.20
124-084-04	RESID. SINGLE FAMILY	0.9	\$42.44	\$38.20
124-084-05	RESID. SINGLE FAMILY	0.9	\$42.44	\$38.20
124-084-06	RESID. SINGLE FAMILY	0.9	\$42.44	\$38.20
124-084-07	RESID. SINGLE FAMILY	0.9	\$42.44	\$38.20
124-084-08	RESID. SINGLE FAMILY	0.9	\$42.44	\$38.20



APN	Land Use	EDU	Assessment Rate	Assessment
124-084-09	RESID. SINGLE FAMILY	0.9	\$42.44	\$38.20
124-091-01	RESID. SINGLE FAMILY	0.9	\$42.44	\$38.20
124-091-02	RESID. SINGLE FAMILY	0.9	\$42.44	\$38.20
124-091-09	RESID. SINGLE FAMILY	1	\$42.44	\$42.44
124-091-10	RESID. SINGLE FAMILY	0.9	\$42.44	\$38.20
124-091-11	RESID. SINGLE FAMILY	0.9	\$42.44	\$38.20
124-091-12	RESID. SINGLE FAMILY	1	\$42.44	\$42.44
124-092-01	RESID. SINGLE FAMILY	1	\$42.44	\$42.44
124-092-02	RESID. SINGLE FAMILY	0.9	\$42.44	\$38.20
124-092-03	RESID. SINGLE FAMILY	0.9	\$42.44	\$38.20
124-092-04	RESID. SINGLE FAMILY	0.9	\$42.44	\$38.20
124-092-05	RESID. MULTIPLE FAMILY	2	\$42.44	\$84.88
124-092-06	RESID. SINGLE FAMILY	0.9	\$42.44	\$38.20
124-092-07	RESID. SINGLE FAMILY	0.9	\$42.44	\$38.20
124-092-08	RESID. SINGLE FAMILY	0.9	\$42.44	\$38.20
124-092-09	RESID. SINGLE FAMILY	0.9	\$42.44	\$38.20
124-092-10	RESID. SINGLE FAMILY	0.9	\$42.44	\$38.20
124-092-11	RESID. SINGLE FAMILY	0.9	\$42.44	\$38.20
124-092-12	RESID. SINGLE FAMILY	0.9	\$42.44	\$38.20
124-092-13	RESID. SINGLE FAMILY	0.9	\$42.44	\$38.20
124-092-14	RESID. SINGLE FAMILY	0.9	\$42.44	\$38.20
124-093-01	TAX EXEMPTS	0	\$42.44	\$0.00
124-093-02	RESID. SINGLE FAMILY	0.9	\$42.44	\$38.20
124-093-03	RESID. SINGLE FAMILY	0.9	\$42.44	\$38.20
124-093-04	RESID. SINGLE FAMILY	0.9	\$42.44	\$38.20
124-093-05	RESID. SINGLE FAMILY	0.9	\$42.44	\$38.20
124-093-06	RESID. SINGLE FAMILY	0.9	\$42.44	\$38.20
124-093-07	RESID. SINGLE FAMILY	0.9	\$42.44	\$38.20
124-093-08	RESID. SINGLE FAMILY	0.9	\$42.44	\$38.20
124-093-09	RESID. SINGLE FAMILY	0.9	\$42.44	\$38.20
124-093-10	RESID. SINGLE FAMILY	0.9	\$42.44	\$38.20
124-093-11	RESID. SINGLE FAMILY	0.9	\$42.44	\$38.20
124-093-13	RESID. SINGLE FAMILY	0.9	\$42.44	\$38.20
124-093-14	RESID. SINGLE FAMILY	0.9	\$42.44	\$38.20
124-093-15	RESID. SINGLE FAMILY	0.9	\$42.44	\$38.20
124-093-22	RESID. SINGLE FAMILY	0.9	\$42.44	\$38.20
124-093-25	RESID. SINGLE FAMILY	0.9	\$42.44	\$38.20
124-093-27	TAX EXEMPTS	0	\$42.44	\$0.00
124-093-28	RESID. SINGLE FAMILY	0.9	\$42.44	\$38.20
124-093-29	RESID. SINGLE FAMILY	0.9	\$42.44	\$38.20
124-094-01	RESID. SINGLE FAMILY	0.9	\$42.44	\$38.20



APN	Land Use	EDU	Assessment Rate	Assessment
124-094-04	RESID. SINGLE FAMILY	0.9	\$42.44	\$38.20
124-094-05	RESID. SINGLE FAMILY	0.9	\$42.44	\$38.20
124-094-06	RESID. SINGLE FAMILY	0.9	\$42.44	\$38.20
124-094-07	RESID. SINGLE FAMILY	0.9	\$42.44	\$38.20
124-094-08	RESID. SINGLE FAMILY	0.9	\$42.44	\$38.20
124-094-09	RESID. SINGLE FAMILY	0.9	\$42.44	\$38.20
124-094-10	RESID. SINGLE FAMILY	0.9	\$42.44	\$38.20
124-094-11	RESID. SINGLE FAMILY	0.9	\$42.44	\$38.20
124-094-12	RESID. SINGLE FAMILY	1	\$42.44	\$42.44
124-094-13	RESID. SINGLE FAMILY	1	\$42.44	\$42.44
124-094-14	RESID. SINGLE FAMILY	0.9	\$42.44	\$38.20
124-094-15	RESID. SINGLE FAMILY	0.9	\$42.44	\$38.20
124-094-19	RESID. SINGLE FAMILY	0.9	\$42.44	\$38.20
124-094-24	RESID. SINGLE FAMILY	0.9	\$42.44	\$38.20
124-094-25	RESID. SINGLE FAMILY	0.9	\$42.44	\$38.20
124-094-26	RESID. SINGLE FAMILY	0.9	\$42.44	\$38.20
124-094-27	RESID. SINGLE FAMILY	0.9	\$42.44	\$38.20
124-101-01	RESID. SINGLE FAMILY	0.9	\$42.44	\$38.20
124-101-02	RESID. SINGLE FAMILY	0.9	\$42.44	\$38.20
124-101-03	RESID. SINGLE FAMILY	0.9	\$42.44	\$38.20
124-101-04	RESID. SINGLE FAMILY	0.9	\$42.44	\$38.20
124-101-05	RESID. SINGLE FAMILY	0.9	\$42.44	\$38.20
124-101-06	RESID. SINGLE FAMILY	0.9	\$42.44	\$38.20
124-101-07	RESID. SINGLE FAMILY	0.9	\$42.44	\$38.20
124-101-08	RESID. SINGLE FAMILY	0.9	\$42.44	\$38.20
124-101-09	TAX EXEMPTS	0.9	\$42.44	\$38.20
124-101-10	RESID. SINGLE FAMILY	0.9	\$42.44	\$38.20
124-101-11	RESID. SINGLE FAMILY	0.9	\$42.44	\$38.20
124-101-12	RESID. SINGLE FAMILY	0.9	\$42.44	\$38.20
124-101-13	RESID. SINGLE FAMILY	0.9	\$42.44	\$38.20
124-101-14	RESID. SINGLE FAMILY	0.9	\$42.44	\$38.20
124-101-15	RESID. SINGLE FAMILY	0.9	\$42.44	\$38.20
124-101-16	RESID. SINGLE FAMILY	0.9	\$42.44	\$38.20
124-101-17	RESID. SINGLE FAMILY	0.9	\$42.44	\$38.20
124-101-18	RESID. SINGLE FAMILY	0.9	\$42.44	\$38.20
124-101-19	RESID. SINGLE FAMILY	0.9	\$42.44	\$38.20
124-101-20	RESID. SINGLE FAMILY	0.9	\$42.44	\$38.20
124-101-21	RESID. SINGLE FAMILY	0.9	\$42.44	\$38.20
124-101-22	RESID. SINGLE FAMILY	0.9	\$42.44	\$38.20
124-102-01	RESID. SINGLE FAMILY	0.9	\$42.44	\$38.20
124-102-02	RESID. SINGLE FAMILY	0.9	\$42.44	\$38.20



APN	Land Use	EDU	Assessment Rate	Assessment
124-102-03	RESID. SINGLE FAMILY	0.9	\$42.44	\$38.20
124-102-04	RESID. SINGLE FAMILY	0.9	\$42.44	\$38.20
124-102-05	RESID. SINGLE FAMILY	0.9	\$42.44	\$38.20
124-102-06	RESID. SINGLE FAMILY	0.9	\$42.44	\$38.20
124-102-07	RESID. SINGLE FAMILY	0.9	\$42.44	\$38.20
124-102-08	RESID. SINGLE FAMILY	0.9	\$42.44	\$38.20
124-102-09	RESID. SINGLE FAMILY	0.9	\$42.44	\$38.20
124-102-10	RESID. SINGLE FAMILY	0.9	\$42.44	\$38.20
124-102-11	RESID. SINGLE FAMILY	0.9	\$42.44	\$38.20
124-102-12	RESID. SINGLE FAMILY	0.9	\$42.44	\$38.20
124-102-13	RESID. SINGLE FAMILY	0.9	\$42.44	\$38.20
124-102-14	RESID. SINGLE FAMILY	0.9	\$42.44	\$38.20
124-102-15	RESID. SINGLE FAMILY	0.9	\$42.44	\$38.20
124-102-18	TAX EXEMPTS	0	\$42.44	\$0.00
124-111-01	RESID. SINGLE FAMILY	0.9	\$42.44	\$38.20
124-111-02	RESID. SINGLE FAMILY	0.9	\$42.44	\$38.20
124-111-03	RESID. SINGLE FAMILY	1	\$42.44	\$42.44
124-111-04	RESID. SINGLE FAMILY	1	\$42.44	\$42.44
124-111-05	RESID. SINGLE FAMILY	1	\$42.44	\$42.44
124-111-06	RESID. SINGLE FAMILY	1	\$42.44	\$42.44
124-111-07	RESID. SINGLE FAMILY	1	\$42.44	\$42.44
124-111-08	RESID. SINGLE FAMILY	1	\$42.44	\$42.44
124-111-09	RESID. SINGLE FAMILY	1	\$42.44	\$42.44
124-111-10	RESID. SINGLE FAMILY	1	\$42.44	\$42.44
124-111-11	RESID. SINGLE FAMILY	1	\$42.44	\$42.44
124-111-12	RESID. SINGLE FAMILY	1	\$42.44	\$42.44
124-111-13	RESID. SINGLE FAMILY	1	\$42.44	\$42.44
124-111-14	RESID. SINGLE FAMILY	1	\$42.44	\$42.44
124-111-15	RESID. SINGLE FAMILY	0.9	\$42.44	\$38.20
124-111-16	RESID. SINGLE FAMILY	0.9	\$42.44	\$38.20
124-111-17	VACANT	0	\$42.44	\$0.00
124-121-01	RESID. SINGLE FAMILY	0.9	\$42.44	\$38.20
124-121-02	RESID. SINGLE FAMILY	0.9	\$42.44	\$38.20
124-121-03	RESID. SINGLE FAMILY	0.9	\$42.44	\$38.20
124-121-04	RESID. SINGLE FAMILY	0.9	\$42.44	\$38.20
124-121-05	RESID. SINGLE FAMILY	0.9	\$42.44	\$38.20
124-121-06	RESID. SINGLE FAMILY	0.9	\$42.44	\$38.20
124-121-07	RESID. SINGLE FAMILY	0.9	\$42.44	\$38.20
124-121-08	RESID. SINGLE FAMILY	0.9	\$42.44	\$38.20
124-121-09	RESID. SINGLE FAMILY	0.9	\$42.44	\$38.20
124-121-10	RESID. SINGLE FAMILY	0.9	\$42.44	\$38.20



APN	Land Use	EDU	Assessment Rate	Assessment
124-121-11	RESID. SINGLE FAMILY	0.9	\$42.44	\$38.20
124-121-12	RESID. SINGLE FAMILY	0.9	\$42.44	\$38.20
124-121-13	RESID. SINGLE FAMILY	0.9	\$42.44	\$38.20
124-121-14	RESID. SINGLE FAMILY	0.9	\$42.44	\$38.20
124-121-15	RESID. SINGLE FAMILY	0.9	\$42.44	\$38.20
124-121-16	RESID. SINGLE FAMILY	0.9	\$42.44	\$38.20
124-121-17	RESID. SINGLE FAMILY	0.9	\$42.44	\$38.20
124-121-18	RESID. SINGLE FAMILY	0.9	\$42.44	\$38.20
124-121-19	RESID. SINGLE FAMILY	0.9	\$42.44	\$38.20
124-121-20	RESID. SINGLE FAMILY	0.9	\$42.44	\$38.20
124-121-21	RESID. SINGLE FAMILY	0.9	\$42.44	\$38.20
124-121-22	RESID. SINGLE FAMILY	0.9	\$42.44	\$38.20
124-121-23	RESID. SINGLE FAMILY	0.9	\$42.44	\$38.20
124-121-24	RESID. SINGLE FAMILY	0.9	\$42.44	\$38.20
124-121-25	RESID. SINGLE FAMILY	0.9	\$42.44	\$38.20
124-121-26	RESID. SINGLE FAMILY	0.9	\$42.44	\$38.20
124-121-27	RESID. SINGLE FAMILY	0.9	\$42.44	\$38.20
124-121-28	RESID. SINGLE FAMILY	0.9	\$42.44	\$38.20
124-121-29	RESID. SINGLE FAMILY	0.9	\$42.44	\$38.20
124-121-30	RESID. SINGLE FAMILY	0.9	\$42.44	\$38.20
124-121-31	RESID. SINGLE FAMILY	0.9	\$42.44	\$38.20
124-121-32	RESID. SINGLE FAMILY	0.9	\$42.44	\$38.20
124-121-33	RESID. SINGLE FAMILY	0.9	\$42.44	\$38.20
124-121-34	RESID. SINGLE FAMILY	0.9	\$42.44	\$38.20
124-121-35	RESID. SINGLE FAMILY	0.9	\$42.44	\$38.20
124-121-36	RESID. SINGLE FAMILY	0.9	\$42.44	\$38.20
124-121-37	RESID. SINGLE FAMILY	0.9	\$42.44	\$38.20
124-121-38	RESID. SINGLE FAMILY	0.9	\$42.44	\$38.20
124-121-39	RESID. SINGLE FAMILY	0.9	\$42.44	\$38.20
124-121-40	RESID. SINGLE FAMILY	0.9	\$42.44	\$38.20
124-121-41	RESID. SINGLE FAMILY	0.9	\$42.44	\$38.20
124-121-42	RESID. SINGLE FAMILY	0.9	\$42.44	\$38.20
124-121-43	RESID. SINGLE FAMILY	0.9	\$42.44	\$38.20
124-121-44	RESID. SINGLE FAMILY	0.9	\$42.44	\$38.20
124-121-45	RESID. SINGLE FAMILY	0.9	\$42.44	\$38.20
124-121-46	RESID. SINGLE FAMILY	0.9	\$42.44	\$38.20
124-121-47	RESID. SINGLE FAMILY	0.9	\$42.44	\$38.20
124-121-48	RESID. SINGLE FAMILY	0.9	\$42.44	\$38.20
124-121-49	RESID. SINGLE FAMILY	0.9	\$42.44	\$38.20
124-121-50	RESID. SINGLE FAMILY	0.9	\$42.44	\$38.20
124-121-51	RESID. SINGLE FAMILY	0.9	\$42.44	\$38.20



APN	Land Use	EDU	Assessment Rate	Assessment
124-121-52	RESID. SINGLE FAMILY	0.9	\$42.44	\$38.20
124-121-53	RESID. SINGLE FAMILY	0.9	\$42.44	\$38.20
124-121-54	RESID. SINGLE FAMILY	0.9	\$42.44	\$38.20
124-121-55	RESID. SINGLE FAMILY	0.9	\$42.44	\$38.20
124-121-56	RESID. SINGLE FAMILY	0.9	\$42.44	\$38.20
124-121-57	RESID. SINGLE FAMILY	0.9	\$42.44	\$38.20
124-121-58	RESID. SINGLE FAMILY	0.9	\$42.44	\$38.20
124-121-59	RESID. SINGLE FAMILY	0.9	\$42.44	\$38.20
124-121-60	RESID. SINGLE FAMILY	0.9	\$42.44	\$38.20
124-121-61	RESID. SINGLE FAMILY	0.9	\$42.44	\$38.20
124-121-62	RESID. SINGLE FAMILY	0.9	\$42.44	\$38.20
124-121-63	RESID. SINGLE FAMILY	0.9	\$42.44	\$38.20
124-121-64	RESID. SINGLE FAMILY	0.9	\$42.44	\$38.20
124-121-65	RESID. SINGLE FAMILY	0.9	\$42.44	\$38.20
124-121-66	RESID. SINGLE FAMILY	0.9	\$42.44	\$38.20
124-121-67	RESID. SINGLE FAMILY	0.9	\$42.44	\$38.20
124-121-68	RESID. SINGLE FAMILY	0.9	\$42.44	\$38.20
124-121-69	RESID. SINGLE FAMILY	0.9	\$42.44	\$38.20
124-121-70	RESID. SINGLE FAMILY	0.9	\$42.44	\$38.20
124-121-71	RESID. SINGLE FAMILY	0.9	\$42.44	\$38.20
124-121-72	RESID. SINGLE FAMILY	0.9	\$42.44	\$38.20
124-121-73	RESID. SINGLE FAMILY	0.9	\$42.44	\$38.20
124-121-74	RESID. SINGLE FAMILY	0.9	\$42.44	\$38.20
124-121-75	RESID. SINGLE FAMILY	0.9	\$42.44	\$38.20
124-121-76	RESID. SINGLE FAMILY	0.9	\$42.44	\$38.20
124-121-77	RESID. SINGLE FAMILY	0.9	\$42.44	\$38.20
124-121-78	RESID. SINGLE FAMILY	0.9	\$42.44	\$38.20
124-121-79	RESID. SINGLE FAMILY	0.9	\$42.44	\$38.20
124-121-80	RESID. SINGLE FAMILY	0.9	\$42.44	\$38.20
124-121-81	RESID. SINGLE FAMILY	0.9	\$42.44	\$38.20
124-121-82	RESID. SINGLE FAMILY	0.9	\$42.44	\$38.20
124-121-83	RESID. SINGLE FAMILY	0.9	\$42.44	\$38.20
124-121-84	RESID. SINGLE FAMILY	0.9	\$42.44	\$38.20
124-121-85	RESID. SINGLE FAMILY	0.9	\$42.44	\$38.20
124-121-86	RESID. SINGLE FAMILY	0.9	\$42.44	\$38.20
124-121-87	RESID. SINGLE FAMILY	0.9	\$42.44	\$38.20
124-121-88	RESID. SINGLE FAMILY	0.9	\$42.44	\$38.20
124-121-89	RESID. SINGLE FAMILY	0.9	\$42.44	\$38.20
124-121-90	RESID. SINGLE FAMILY	0.9	\$42.44	\$38.20
124-121-91	RESIDENTIAL	0	\$42.44	\$0.00
124-121-92	RESIDENTIAL	0	\$42.44	\$0.00



APN	Land Use	EDU	Assessment Rate	Assessment
124-121-95	RESIDENTIAL	0	\$42.44	\$0.00
124-131-01	RESID. SINGLE FAMILY	0.9	\$42.44	\$38.20
124-131-02	RESID. SINGLE FAMILY	0.9	\$42.44	\$38.20
124-131-03	RESID. SINGLE FAMILY	0.9	\$42.44	\$38.20
124-131-04	RESID. SINGLE FAMILY	0.9	\$42.44	\$38.20
124-131-05	RESID. SINGLE FAMILY	0.9	\$42.44	\$38.20
124-131-06	RESID. SINGLE FAMILY	0.9	\$42.44	\$38.20
124-131-07	RESID. SINGLE FAMILY	0.9	\$42.44	\$38.20
124-131-08	RESID. SINGLE FAMILY	0.9	\$42.44	\$38.20
124-131-09	RESID. SINGLE FAMILY	0.9	\$42.44	\$38.20
124-131-10	RESID. SINGLE FAMILY	0.9	\$42.44	\$38.20
124-131-11	RESID. SINGLE FAMILY	0.9	\$42.44	\$38.20
124-131-12	RESID. SINGLE FAMILY	0.9	\$42.44	\$38.20
124-131-13	RESID. SINGLE FAMILY	0.9	\$42.44	\$38.20
124-131-14	RESID. SINGLE FAMILY	0.9	\$42.44	\$38.20
124-131-15	RESID. SINGLE FAMILY	0.9	\$42.44	\$38.20
124-131-16	RESID. SINGLE FAMILY	0.9	\$42.44	\$38.20
124-131-17	RESID. SINGLE FAMILY	0.9	\$42.44	\$38.20
124-131-18	RESID. SINGLE FAMILY	0.9	\$42.44	\$38.20
124-131-19	RESID. SINGLE FAMILY	0.9	\$42.44	\$38.20
124-131-20	RESID. SINGLE FAMILY	0.9	\$42.44	\$38.20
124-131-21	RESID. SINGLE FAMILY	0.9	\$42.44	\$38.20
124-131-22	RESID. SINGLE FAMILY	0.9	\$42.44	\$38.20
124-131-23	RESID. SINGLE FAMILY	0.9	\$42.44	\$38.20
124-131-24	RESID. SINGLE FAMILY	0.9	\$42.44	\$38.20
124-131-25	RESID. SINGLE FAMILY	0.9	\$42.44	\$38.20
124-131-26	RESID. SINGLE FAMILY	0.9	\$42.44	\$38.20
124-131-27	RESID. SINGLE FAMILY	0.9	\$42.44	\$38.20
124-131-28	RESID. SINGLE FAMILY	0.9	\$42.44	\$38.20
124-131-29	RESID. SINGLE FAMILY	0.9	\$42.44	\$38.20
124-131-30	RESID. SINGLE FAMILY	0.9	\$42.44	\$38.20
124-131-31	RESID. SINGLE FAMILY	0.9	\$42.44	\$38.20
124-131-32	RESID. SINGLE FAMILY	0.9	\$42.44	\$38.20
124-131-33	RESID. SINGLE FAMILY	0.9	\$42.44	\$38.20
124-131-34	RESID. SINGLE FAMILY	0.9	\$42.44	\$38.20
124-131-35	RESID. SINGLE FAMILY	0.9	\$42.44	\$38.20
124-131-36	RESID. SINGLE FAMILY	0.9	\$42.44	\$38.20
124-131-37	RESID. SINGLE FAMILY	0.9	\$42.44	\$38.20
124-131-38	RESID. SINGLE FAMILY	0.9	\$42.44	\$38.20
124-131-39	RESID. SINGLE FAMILY	0.9	\$42.44	\$38.20
124-131-40	RESID. SINGLE FAMILY	0.9	\$42.44	\$38.20



APN	Land Use	EDU	Assessment Rate	Assessment
124-131-41	RESID. SINGLE FAMILY	0.9	\$42.44	\$38.20
124-131-42	RESID. SINGLE FAMILY	0.9	\$42.44	\$38.20
124-131-43	RESID. SINGLE FAMILY	0.9	\$42.44	\$38.20
124-131-44	RESID. SINGLE FAMILY	0.9	\$42.44	\$38.20
124-131-45	RESID. SINGLE FAMILY	0.9	\$42.44	\$38.20
124-131-46	RESID. SINGLE FAMILY	0.9	\$42.44	\$38.20
124-131-47	RESID. SINGLE FAMILY	0.9	\$42.44	\$38.20
124-131-48	RESID. SINGLE FAMILY	0.9	\$42.44	\$38.20
124-131-49	RESID. SINGLE FAMILY	0.9	\$42.44	\$38.20
124-131-50	RESID. SINGLE FAMILY	0.9	\$42.44	\$38.20
124-131-51	RESID. SINGLE FAMILY	0.9	\$42.44	\$38.20
124-131-52	RESID. SINGLE FAMILY	0.9	\$42.44	\$38.20
124-131-53	RESID. SINGLE FAMILY	0.9	\$42.44	\$38.20
124-131-54	RESID. SINGLE FAMILY	0.9	\$42.44	\$38.20
124-131-55	RESID. SINGLE FAMILY	0.9	\$42.44	\$38.20
124-131-56	RESID. SINGLE FAMILY	0.9	\$42.44	\$38.20
124-131-57	RESIDENTIAL	0	\$42.44	\$0.00
124-131-58	RESIDENTIAL	0	\$42.44	\$0.00
124-131-59	RESIDENTIAL	0	\$42.44	\$0.00
124-161-02	RESID. SINGLE FAMILY	0.9	\$42.44	\$38.20
124-161-03	RESID. SINGLE FAMILY	0.9	\$42.44	\$38.20
124-161-04	RESID. SINGLE FAMILY	0.9	\$42.44	\$38.20
124-161-05	RESID. SINGLE FAMILY	0.9	\$42.44	\$38.20
124-161-06	RESID. SINGLE FAMILY	0.9	\$42.44	\$38.20
124-161-07	RESID. SINGLE FAMILY	0.9	\$42.44	\$38.20
124-161-08	RESID. SINGLE FAMILY	0.9	\$42.44	\$38.20
124-161-09	RESID. SINGLE FAMILY	0.9	\$42.44	\$38.20
124-161-10	RESID. SINGLE FAMILY	0.9	\$42.44	\$38.20
124-161-11	RESID. SINGLE FAMILY	0.9	\$42.44	\$38.20
124-161-12	RESID. SINGLE FAMILY	0.9	\$42.44	\$38.20
124-161-13	RESID. SINGLE FAMILY	0.9	\$42.44	\$38.20
124-161-14	RESID. SINGLE FAMILY	0.9	\$42.44	\$38.20
124-161-15	RESID. SINGLE FAMILY	0.9	\$42.44	\$38.20
124-161-16	RESID. SINGLE FAMILY	0.9	\$42.44	\$38.20
124-161-17	RESID. SINGLE FAMILY	0.9	\$42.44	\$38.20
124-161-18	RESID. SINGLE FAMILY	0.9	\$42.44	\$38.20
124-161-19	RESID. SINGLE FAMILY	0.9	\$42.44	\$38.20
124-161-20	RESID. SINGLE FAMILY	0.9	\$42.44	\$38.20
124-161-21	RESID. SINGLE FAMILY	0.9	\$42.44	\$38.20
124-161-22	RESID. SINGLE FAMILY	0.9	\$42.44	\$38.20
124-161-23	RESID. SINGLE FAMILY	0.9	\$42.44	\$38.20



APN	Land Use	EDU	Assessment Rate	Assessment
124-161-24	RESID. SINGLE FAMILY	0.9	\$42.44	\$38.20
124-161-25	RESID. SINGLE FAMILY	0.9	\$42.44	\$38.20
124-161-26	RESID. SINGLE FAMILY	0.9	\$42.44	\$38.20
124-161-27	TAX EXEMPTS	0	\$42.44	\$0.00
124-171-02	RESID. SINGLE FAMILY	0.9	\$42.44	\$38.20
124-171-03	RESID. SINGLE FAMILY	0.9	\$42.44	\$38.20
124-171-04	RESID. SINGLE FAMILY	0.9	\$42.44	\$38.20
124-171-05	RESID. SINGLE FAMILY	0.9	\$42.44	\$38.20
124-171-06	RESID. SINGLE FAMILY	0.9	\$42.44	\$38.20
124-171-07	RESID. SINGLE FAMILY	0.9	\$42.44	\$38.20
124-171-08	RESID. SINGLE FAMILY	0.9	\$42.44	\$38.20
124-171-09	RESID. SINGLE FAMILY	0.9	\$42.44	\$38.20
124-171-10	RESID. SINGLE FAMILY	0.9	\$42.44	\$38.20
124-171-11	RESID. SINGLE FAMILY	0.9	\$42.44	\$38.20
124-171-12	RESID. SINGLE FAMILY	0.9	\$42.44	\$38.20
124-171-13	RESID. SINGLE FAMILY	0.9	\$42.44	\$38.20
124-171-14	RESID. SINGLE FAMILY	0.9	\$42.44	\$38.20
124-171-15	RESID. SINGLE FAMILY	0.9	\$42.44	\$38.20
124-171-16	RESID. SINGLE FAMILY	0.9	\$42.44	\$38.20
124-171-17	RESID. SINGLE FAMILY	0.9	\$42.44	\$38.20
124-171-18	RESID. SINGLE FAMILY	0.9	\$42.44	\$38.20
124-171-19	RESID. SINGLE FAMILY	0.9	\$42.44	\$38.20
124-171-20	TAX EXEMPTS	0	\$42.44	\$0.00
124-172-01	TAX EXEMPTS	0.9	\$42.44	\$38.20
124-172-02	RESID. SINGLE FAMILY	0.9	\$42.44	\$38.20
124-172-03	RESID. SINGLE FAMILY	0.9	\$42.44	\$38.20
124-172-04	RESID. SINGLE FAMILY	0.9	\$42.44	\$38.20
124-172-05	RESID. SINGLE FAMILY	0.9	\$42.44	\$38.20
124-172-06	RESID. SINGLE FAMILY	0.9	\$42.44	\$38.20
124-172-07	RESID. SINGLE FAMILY	0.9	\$42.44	\$38.20
124-191-05	TAX EXEMPTS	0	\$42.44	\$0.00
124-191-06	COMMERCIAL	11.384	\$42.44	\$483.14
124-201-01	COMMERCIAL	12.66	\$42.44	\$537.28
124-202-02	RESID. SINGLE FAMILY	0.9	\$42.44	\$38.20
124-202-03	RESID. SINGLE FAMILY	0.9	\$42.44	\$38.20
124-202-04	RESID. SINGLE FAMILY	0.9	\$42.44	\$38.20
124-202-05	RESID. SINGLE FAMILY	0.9	\$42.44	\$38.20
124-202-06	RESID. SINGLE FAMILY	0.9	\$42.44	\$38.20
124-202-07	RESID. SINGLE FAMILY	0.9	\$42.44	\$38.20
124-202-08	RESID. SINGLE FAMILY	0.9	\$42.44	\$38.20
124-202-09	RESID. SINGLE FAMILY	0.9	\$42.44	\$38.20



APN	Land Use	EDU	Assessment Rate	Assessment
124-202-10	RESID. SINGLE FAMILY	0.9	\$42.44	\$38.20
124-202-11	RESID. SINGLE FAMILY	0.9	\$42.44	\$38.20
124-202-12	RESID. SINGLE FAMILY	0.9	\$42.44	\$38.20
124-202-13	RESID. SINGLE FAMILY	0.9	\$42.44	\$38.20
124-202-14	RESID. SINGLE FAMILY	0.9	\$42.44	\$38.20
124-202-15	RESID. SINGLE FAMILY	0.9	\$42.44	\$38.20
124-202-16	RESID. SINGLE FAMILY	0.9	\$42.44	\$38.20
124-202-17	RESID. SINGLE FAMILY	0.9	\$42.44	\$38.20
124-202-18	RESID. SINGLE FAMILY	0.9	\$42.44	\$38.20
124-202-19	RESID. SINGLE FAMILY	0.9	\$42.44	\$38.20
124-202-20	RESID. SINGLE FAMILY	0.9	\$42.44	\$38.20
124-202-21	RESID. SINGLE FAMILY	0.9	\$42.44	\$38.20
124-202-22	RESID. SINGLE FAMILY	0.9	\$42.44	\$38.20
124-202-23	RESID. SINGLE FAMILY	0.9	\$42.44	\$38.20
124-202-24	RESID. SINGLE FAMILY	0.9	\$42.44	\$38.20
124-202-25	RESID. SINGLE FAMILY	0.9	\$42.44	\$38.20
124-202-26	RESID. SINGLE FAMILY	0.9	\$42.44	\$38.20
124-202-28	COMMERCIAL	18.097	\$42.44	\$768.04
124-203-01	RESID. SINGLE FAMILY	0.9	\$42.44	\$38.20
124-203-02	RESID. SINGLE FAMILY	0.9	\$42.44	\$38.20
124-203-03	RESID. SINGLE FAMILY	0.9	\$42.44	\$38.20
124-203-04	RESID. SINGLE FAMILY	0.9	\$42.44	\$38.20
124-203-05	RESID. SINGLE FAMILY	0.9	\$42.44	\$38.20
124-203-06	RESID. SINGLE FAMILY	0.9	\$42.44	\$38.20
124-203-07	RESID. SINGLE FAMILY	0.9	\$42.44	\$38.20
124-203-08	RESID. SINGLE FAMILY	0.9	\$42.44	\$38.20
124-203-09	RESID. SINGLE FAMILY	0.9	\$42.44	\$38.20
124-203-10	RESID. SINGLE FAMILY	0.9	\$42.44	\$38.20
124-211-01	RESID. SINGLE FAMILY	0.9	\$42.44	\$38.20
124-211-02	RESID. SINGLE FAMILY	0.9	\$42.44	\$38.20
124-211-03	RESID. SINGLE FAMILY	0.9	\$42.44	\$38.20
124-211-04	RESID. SINGLE FAMILY	0.9	\$42.44	\$38.20
124-211-05	RESID. SINGLE FAMILY	0.9	\$42.44	\$38.20
124-211-06	RESID. SINGLE FAMILY	0.9	\$42.44	\$38.20
124-211-07	RESID. SINGLE FAMILY	0.9	\$42.44	\$38.20
124-211-08	RESID. SINGLE FAMILY	0.9	\$42.44	\$38.20
124-211-09	RESID. SINGLE FAMILY	0.9	\$42.44	\$38.20
124-211-10	RESID. SINGLE FAMILY	0.9	\$42.44	\$38.20
124-211-11	RESID. SINGLE FAMILY	0.9	\$42.44	\$38.20
124-211-12	RESID. SINGLE FAMILY	0.9	\$42.44	\$38.20
124-211-13	RESID. SINGLE FAMILY	0.9	\$42.44	\$38.20



APN	Land Use	EDU	Assessment Rate	Assessment
124-211-14	RESID. SINGLE FAMILY	0.9	\$42.44	\$38.20
124-211-15	RESID. SINGLE FAMILY	0.9	\$42.44	\$38.20
124-211-16	RESID. SINGLE FAMILY	0.9	\$42.44	\$38.20
124-211-17	RESID. SINGLE FAMILY	0.9	\$42.44	\$38.20
124-211-18	RESID. SINGLE FAMILY	0.9	\$42.44	\$38.20
124-211-19	RESID. SINGLE FAMILY	0.9	\$42.44	\$38.20
124-211-20	RESID. MULTIPLE FAMILY	2	\$42.44	\$84.88
124-211-21	RESID. MULTIPLE FAMILY	2	\$42.44	\$84.88
124-211-26	RESID. SINGLE FAMILY	0.9	\$42.44	\$38.20
124-211-27	RESID. SINGLE FAMILY	0.9	\$42.44	\$38.20
124-211-28	RESID. SINGLE FAMILY	1	\$42.44	\$42.44
124-211-29	RESID. SINGLE FAMILY	1	\$42.44	\$42.44
124-211-30	RESID. SINGLE FAMILY	1	\$42.44	\$42.44
124-211-31	RESID. SINGLE FAMILY	0.9	\$42.44	\$38.20
124-211-32	RESID. SINGLE FAMILY	0.9	\$42.44	\$38.20
124-211-33	RESID. SINGLE FAMILY	0.9	\$42.44	\$38.20
124-211-34	RESID. SINGLE FAMILY	0.9	\$42.44	\$38.20
124-211-35	RESID. SINGLE FAMILY	0.9	\$42.44	\$38.20
124-211-36	RESID. SINGLE FAMILY	0.9	\$42.44	\$38.20
124-211-37	RESID. SINGLE FAMILY	0.9	\$42.44	\$38.20
124-211-38	RESID. SINGLE FAMILY	0.9	\$42.44	\$38.20
124-211-39	RESID. SINGLE FAMILY	0.9	\$42.44	\$38.20
124-211-40	RESID. SINGLE FAMILY	0.9	\$42.44	\$38.20
124-211-41	RESID. SINGLE FAMILY	0.9	\$42.44	\$38.20
124-211-42	RESID. SINGLE FAMILY	0.9	\$42.44	\$38.20
124-211-43	RESID. SINGLE FAMILY	0.9	\$42.44	\$38.20
124-211-44	RESID. SINGLE FAMILY	0.9	\$42.44	\$38.20
124-211-45	RESID. SINGLE FAMILY	0.9	\$42.44	\$38.20
124-211-54	RESID. SINGLE FAMILY	1	\$42.44	\$42.44
124-211-55	RESID. SINGLE FAMILY	1	\$42.44	\$42.44
124-211-56	RESID. SINGLE FAMILY	1	\$42.44	\$42.44
124-211-57	RESID. SINGLE FAMILY	1	\$42.44	\$42.44
124-211-58	RESID. SINGLE FAMILY	1	\$42.44	\$42.44
124-212-03	RESID. SINGLE FAMILY	0.9	\$42.44	\$38.20
124-212-04	RESID. SINGLE FAMILY	0.9	\$42.44	\$38.20
124-212-05	RESID. SINGLE FAMILY	0.9	\$42.44	\$38.20
124-212-06	RESID. SINGLE FAMILY	0.9	\$42.44	\$38.20
124-212-07	RESID. SINGLE FAMILY	0.9	\$42.44	\$38.20
124-212-08	RESID. SINGLE FAMILY	0.9	\$42.44	\$38.20
124-212-09	RESID. SINGLE FAMILY	0.9	\$42.44	\$38.20
124-212-10	RESID. SINGLE FAMILY	0.9	\$42.44	\$38.20

APN	Land Use	EDU	Assessment Rate	Assessment
124-212-11	RESID. SINGLE FAMILY	0.9	\$42.44	\$38.20
124-212-12	RESID. SINGLE FAMILY	0.9	\$42.44	\$38.20
124-212-13	RESID. SINGLE FAMILY	0.9	\$42.44	\$38.20
124-212-14	RESID. SINGLE FAMILY	0.9	\$42.44	\$38.20
124-212-15	RESID. SINGLE FAMILY	0.9	\$42.44	\$38.20
124-212-17	TAX EXEMPTS	0	\$42.44	\$0.00
124-212-22	TAX EXEMPTS	13.6	\$42.44	\$577.18
124-212-23	TAX EXEMPTS	0	\$42.44	\$0.00
124-213-01	RESID. SINGLE FAMILY	0.9	\$42.44	\$38.20
124-213-02	RESID. SINGLE FAMILY	0.9	\$42.44	\$38.20
124-213-03	RESID. SINGLE FAMILY	0.9	\$42.44	\$38.20
124-213-04	RESID. SINGLE FAMILY	0.9	\$42.44	\$38.20
124-213-05	RESID. SINGLE FAMILY	0.9	\$42.44	\$38.20
124-213-06	RESID. SINGLE FAMILY	0.9	\$42.44	\$38.20
124-213-07	RESID. SINGLE FAMILY	0.9	\$42.44	\$38.20
124-213-08	RESID. SINGLE FAMILY	0.9	\$42.44	\$38.20
124-213-09	RESID. SINGLE FAMILY	0.9	\$42.44	\$38.20
124-213-10	RESID. SINGLE FAMILY	0.9	\$42.44	\$38.20
124-213-11	RESID. SINGLE FAMILY	0.9	\$42.44	\$38.20
124-213-12	RESID. SINGLE FAMILY	0.9	\$42.44	\$38.20
124-213-13	RESID. SINGLE FAMILY	0.9	\$42.44	\$38.20
124-213-14	RESID. SINGLE FAMILY	1	\$42.44	\$42.44
124-213-15	RESID. SINGLE FAMILY	1	\$42.44	\$42.44
124-221-01	TAX EXEMPTS	0	\$42.44	\$0.00
124-221-02	RESID. SINGLE FAMILY	0.9	\$42.44	\$38.20
124-221-03	RESID. SINGLE FAMILY	0.9	\$42.44	\$38.20
124-221-04	RESID. SINGLE FAMILY	0.9	\$42.44	\$38.20
124-221-05	RESID. SINGLE FAMILY	0.9	\$42.44	\$38.20
124-221-06	RESID. SINGLE FAMILY	0.9	\$42.44	\$38.20
124-221-07	RESID. SINGLE FAMILY	0.9	\$42.44	\$38.20
124-221-08	RESID. SINGLE FAMILY	0.9	\$42.44	\$38.20
124-221-09	RESID. SINGLE FAMILY	0.9	\$42.44	\$38.20
124-221-10	RESID. SINGLE FAMILY	0.9	\$42.44	\$38.20
124-221-11	RESID. SINGLE FAMILY	0.9	\$42.44	\$38.20
124-221-12	RESID. SINGLE FAMILY	0.9	\$42.44	\$38.20
124-221-13	RESID. SINGLE FAMILY	0.9	\$42.44	\$38.20
124-221-14	RESID. SINGLE FAMILY	0.9	\$42.44	\$38.20
124-221-15	RESID. SINGLE FAMILY	0.9	\$42.44	\$38.20
124-221-16	RESID. SINGLE FAMILY	0.9	\$42.44	\$38.20
124-221-17	RESID. SINGLE FAMILY	0.9	\$42.44	\$38.20
124-221-18	RESID. SINGLE FAMILY	0.9	\$42.44	\$38.20



APN	Land Use	EDU	Assessment Rate	Assessment
124-221-19	RESID. SINGLE FAMILY	0.9	\$42.44	\$38.20
124-221-20	RESID. SINGLE FAMILY	0.9	\$42.44	\$38.20
124-221-21	RESID. SINGLE FAMILY	0.9	\$42.44	\$38.20
124-221-22	RESID. SINGLE FAMILY	0.9	\$42.44	\$38.20
124-221-23	RESID. SINGLE FAMILY	0.9	\$42.44	\$38.20
124-222-01	TAX EXEMPTS	0	\$42.44	\$0.00
124-222-02	RESID. SINGLE FAMILY	0.9	\$42.44	\$38.20
124-222-03	RESID. SINGLE FAMILY	0.9	\$42.44	\$38.20
124-222-04	RESID. SINGLE FAMILY	0.9	\$42.44	\$38.20
124-222-05	RESID. SINGLE FAMILY	0.9	\$42.44	\$38.20
124-222-06	RESID. SINGLE FAMILY	0.9	\$42.44	\$38.20
124-222-07	RESID. SINGLE FAMILY	0.9	\$42.44	\$38.20
124-222-08	RESID. SINGLE FAMILY	0.9	\$42.44	\$38.20
124-222-09	RESID. SINGLE FAMILY	0.9	\$42.44	\$38.20
124-222-10	RESID. SINGLE FAMILY	0.9	\$42.44	\$38.20
124-222-11	RESID. SINGLE FAMILY	0.9	\$42.44	\$38.20
124-222-12	RESID. SINGLE FAMILY	0.9	\$42.44	\$38.20
124-222-13	RESID. SINGLE FAMILY	0.9	\$42.44	\$38.20
124-222-14	RESID. SINGLE FAMILY	0.9	\$42.44	\$38.20
124-222-15	RESID. SINGLE FAMILY	0.9	\$42.44	\$38.20
124-222-16	RESID. SINGLE FAMILY	0.9	\$42.44	\$38.20
124-222-17	RESID. SINGLE FAMILY	0.9	\$42.44	\$38.20
124-222-18	RESID. SINGLE FAMILY	0.9	\$42.44	\$38.20
124-222-19	RESID. SINGLE FAMILY	0.9	\$42.44	\$38.20
124-222-20	RESID. SINGLE FAMILY	0.9	\$42.44	\$38.20
124-222-21	RESID. SINGLE FAMILY	0.9	\$42.44	\$38.20
124-222-22	RESID. SINGLE FAMILY	0.9	\$42.44	\$38.20
124-222-23	RESID. SINGLE FAMILY	0.9	\$42.44	\$38.20
124-222-24	RESID. SINGLE FAMILY	0.9	\$42.44	\$38.20
124-222-25	RESID. SINGLE FAMILY	0.9	\$42.44	\$38.20
124-222-26	RESID. SINGLE FAMILY	0.9	\$42.44	\$38.20
124-222-27	RESID. SINGLE FAMILY	0.9	\$42.44	\$38.20
124-222-28	TAX EXEMPTS	0.9	\$42.44	\$38.20
124-222-32	RESID. SINGLE FAMILY	0.9	\$42.44	\$38.20
124-222-33	RESID. SINGLE FAMILY	0.9	\$42.44	\$38.20
124-222-34	RESID. SINGLE FAMILY	0.9	\$42.44	\$38.20
124-222-35	RESID. SINGLE FAMILY	0.9	\$42.44	\$38.20
124-222-36	RESID. SINGLE FAMILY	0.9	\$42.44	\$38.20
124-222-37	TAX EXEMPTS	0	\$42.44	\$0.00
124-222-38	RESID. SINGLE FAMILY	0.9	\$42.44	\$38.20
124-222-39	RESID. SINGLE FAMILY	0.9	\$42.44	\$38.20



APN	Land Use	EDU	Assessment Rate	Assessment
124-222-43	RESID. SINGLE FAMILY	0.9	\$42.44	\$38.20
124-222-44	RESID. SINGLE FAMILY	0.9	\$42.44	\$38.20
124-222-45	RESID. SINGLE FAMILY	0.9	\$42.44	\$38.20
124-223-01	RESID. SINGLE FAMILY	0.9	\$42.44	\$38.20
124-223-02	RESID. SINGLE FAMILY	0.9	\$42.44	\$38.20
124-223-03	RESID. SINGLE FAMILY	0.9	\$42.44	\$38.20
124-223-04	RESID. SINGLE FAMILY	0.9	\$42.44	\$38.20
124-223-05	RESID. SINGLE FAMILY	0.9	\$42.44	\$38.20
124-223-06	RESID. SINGLE FAMILY	0.9	\$42.44	\$38.20
124-223-07	RESID. SINGLE FAMILY	0.9	\$42.44	\$38.20
124-223-08	RESID. SINGLE FAMILY	0.9	\$42.44	\$38.20
124-223-09	RESID. SINGLE FAMILY	0.9	\$42.44	\$38.20
124-223-10	RESID. SINGLE FAMILY	0.9	\$42.44	\$38.20
124-223-11	RESID. SINGLE FAMILY	0.9	\$42.44	\$38.20
124-223-12	RESID. SINGLE FAMILY	0.9	\$42.44	\$38.20
124-223-13	RESID. SINGLE FAMILY	0.9	\$42.44	\$38.20
124-223-14	RESID. SINGLE FAMILY	0.9	\$42.44	\$38.20
124-223-15	TAX EXEMPTS	0.9	\$42.44	\$38.20
124-223-16	RESID. SINGLE FAMILY	0.9	\$42.44	\$38.20
124-223-17	RESID. SINGLE FAMILY	0.9	\$42.44	\$38.20
124-223-18	RESID. SINGLE FAMILY	0.9	\$42.44	\$38.20
124-223-19	RESID. SINGLE FAMILY	0.9	\$42.44	\$38.20
124-223-20	RESID. SINGLE FAMILY	0.9	\$42.44	\$38.20
124-231-01	RESID. SINGLE FAMILY	1	\$42.44	\$42.44
124-231-02	RESID. SINGLE FAMILY	0.9	\$42.44	\$38.20
124-231-03	RESID. SINGLE FAMILY	0.9	\$42.44	\$38.20
124-231-04	RESID. SINGLE FAMILY	0.9	\$42.44	\$38.20
124-231-05	RESID. SINGLE FAMILY	0.9	\$42.44	\$38.20
124-231-06	RESID. SINGLE FAMILY	0.9	\$42.44	\$38.20
124-231-07	RESID. SINGLE FAMILY	0.9	\$42.44	\$38.20
124-231-08	RESID. SINGLE FAMILY	0.9	\$42.44	\$38.20
124-231-09	RESID. SINGLE FAMILY	0.9	\$42.44	\$38.20
124-231-10	RESID. SINGLE FAMILY	0.9	\$42.44	\$38.20
124-231-11	RESID. SINGLE FAMILY	0.9	\$42.44	\$38.20
124-231-12	RESID. SINGLE FAMILY	0.9	\$42.44	\$38.20
124-231-13	RESID. SINGLE FAMILY	0.9	\$42.44	\$38.20
124-231-14	RESID. SINGLE FAMILY	0.9	\$42.44	\$38.20
124-231-15	RESID. SINGLE FAMILY	0.9	\$42.44	\$38.20
124-231-16	RESID. SINGLE FAMILY	0.9	\$42.44	\$38.20
124-231-17	RESID. SINGLE FAMILY	0.9	\$42.44	\$38.20
124-231-18	RESID. SINGLE FAMILY	0.9	\$42.44	\$38.20



APN	Land Use	EDU	Assessment Rate	Assessment
124-231-19	RESID. SINGLE FAMILY	1	\$42.44	\$42.44
124-231-20	RESID. SINGLE FAMILY	1	\$42.44	\$42.44
124-231-21	TAX EXEMPTS	1	\$42.44	\$42.44
124-231-22	RESID. SINGLE FAMILY	1	\$42.44	\$42.44
124-231-23	RESID. SINGLE FAMILY	1	\$42.44	\$42.44
124-232-01	RESID. SINGLE FAMILY	0.9	\$42.44	\$38.20
124-232-02	RESID. SINGLE FAMILY	0.9	\$42.44	\$38.20
124-232-03	RESID. SINGLE FAMILY	0.9	\$42.44	\$38.20
124-232-04	RESID. SINGLE FAMILY	0.9	\$42.44	\$38.20
124-232-05	RESID. SINGLE FAMILY	0.9	\$42.44	\$38.20
124-232-06	RESID. SINGLE FAMILY	0.9	\$42.44	\$38.20
124-232-07	RESID. SINGLE FAMILY	0.9	\$42.44	\$38.20
124-232-08	RESID. SINGLE FAMILY	0.9	\$42.44	\$38.20
124-232-09	RESID. SINGLE FAMILY	0.9	\$42.44	\$38.20
124-232-10	RESID. SINGLE FAMILY	1	\$42.44	\$42.44
124-233-01	RESID. SINGLE FAMILY	1	\$42.44	\$42.44
124-233-02	RESID. SINGLE FAMILY	0.9	\$42.44	\$38.20
124-233-03	RESID. SINGLE FAMILY	0.9	\$42.44	\$38.20
124-233-07	RESID. SINGLE FAMILY	0.9	\$42.44	\$38.20
124-233-08	RESID. SINGLE FAMILY	0.9	\$42.44	\$38.20
124-233-09	RESID. SINGLE FAMILY	0.9	\$42.44	\$38.20
124-240-01	TAX EXEMPTS	0	\$42.44	\$0.00
124-251-01	RESID. SINGLE FAMILY	0.9	\$42.44	\$38.20
124-251-02	RESID. SINGLE FAMILY	0.9	\$42.44	\$38.20
124-251-03	RESID. SINGLE FAMILY	0.9	\$42.44	\$38.20
124-251-04	RESID. SINGLE FAMILY	0.9	\$42.44	\$38.20
124-251-05	RESID. SINGLE FAMILY	0.9	\$42.44	\$38.20
124-251-06	RESID. SINGLE FAMILY	0.9	\$42.44	\$38.20
124-251-07	RESID. SINGLE FAMILY	0.9	\$42.44	\$38.20
124-251-08	RESID. SINGLE FAMILY	1	\$42.44	\$42.44
124-251-09	TAX EXEMPTS	0	\$42.44	\$0.00
124-251-10	RESID. SINGLE FAMILY	1	\$42.44	\$42.44
124-251-11	RESID. SINGLE FAMILY	0.9	\$42.44	\$38.20
124-251-12	RESID. SINGLE FAMILY	0.9	\$42.44	\$38.20
124-251-13	RESID. SINGLE FAMILY	0.9	\$42.44	\$38.20
124-251-14	RESID. SINGLE FAMILY	0.9	\$42.44	\$38.20
124-251-15	RESID. SINGLE FAMILY	0.9	\$42.44	\$38.20
124-251-16	RESID. SINGLE FAMILY	0.9	\$42.44	\$38.20
124-251-17	RESID. SINGLE FAMILY	0.9	\$42.44	\$38.20
124-251-18	RESID. SINGLE FAMILY	0.9	\$42.44	\$38.20
124-251-19	RESID. SINGLE FAMILY	0.9	\$42.44	\$38.20



APN	Land Use	EDU	Assessment Rate	Assessment
124-251-20	RESID. SINGLE FAMILY	0.9	\$42.44	\$38.20
124-251-21	RESID. SINGLE FAMILY	0.9	\$42.44	\$38.20
124-251-22	RESID. SINGLE FAMILY	0.9	\$42.44	\$38.20
124-251-23	RESID. SINGLE FAMILY	0.9	\$42.44	\$38.20
124-251-24	RESID. SINGLE FAMILY	0.9	\$42.44	\$38.20
124-252-01	RESID. SINGLE FAMILY	0.9	\$42.44	\$38.20
124-252-02	RESID. SINGLE FAMILY	0.9	\$42.44	\$38.20
124-252-03	RESID. SINGLE FAMILY	0.9	\$42.44	\$38.20
124-252-04	RESID. SINGLE FAMILY	1	\$42.44	\$42.44
124-252-05	RESID. SINGLE FAMILY	1	\$42.44	\$42.44
124-252-06	RESID. SINGLE FAMILY	1	\$42.44	\$42.44
124-252-07	RESID. SINGLE FAMILY	0.9	\$42.44	\$38.20
124-252-08	RESID. SINGLE FAMILY	0.9	\$42.44	\$38.20
124-252-09	RESID. SINGLE FAMILY	0.9	\$42.44	\$38.20
124-252-10	RESID. SINGLE FAMILY	0.9	\$42.44	\$38.20
124-252-11	RESID. SINGLE FAMILY	0.9	\$42.44	\$38.20
124-252-12	RESID. SINGLE FAMILY	0.9	\$42.44	\$38.20
124-252-13	RESID. SINGLE FAMILY	0.9	\$42.44	\$38.20
124-252-14	RESID. SINGLE FAMILY	0.9	\$42.44	\$38.20
124-252-15	RESID. SINGLE FAMILY	0.9	\$42.44	\$38.20
124-252-16	RESID. SINGLE FAMILY	0.9	\$42.44	\$38.20
124-252-17	RESID. SINGLE FAMILY	0.9	\$42.44	\$38.20
124-252-18	RESID. SINGLE FAMILY	0.9	\$42.44	\$38.20
124-252-19	TAX EXEMPTS	0	\$42.44	\$0.00
124-252-20	RESID. SINGLE FAMILY	0.9	\$42.44	\$38.20
124-252-21	RESID. SINGLE FAMILY	0.9	\$42.44	\$38.20
124-252-22	RESID. SINGLE FAMILY	0.9	\$42.44	\$38.20
124-252-23	RESID. SINGLE FAMILY	0.9	\$42.44	\$38.20
124-252-24	RESID. SINGLE FAMILY	0.9	\$42.44	\$38.20
124-252-25	TAX EXEMPTS	0	\$42.44	\$0.00
124-253-01	RESID. SINGLE FAMILY	1	\$42.44	\$42.44
124-253-02	RESID. SINGLE FAMILY	1	\$42.44	\$42.44
124-253-03	RESID. SINGLE FAMILY	1	\$42.44	\$42.44
124-253-04	RESID. SINGLE FAMILY	1	\$42.44	\$42.44
124-253-05	TAX EXEMPTS	0	\$42.44	\$0.00
124-253-06	RESID. SINGLE FAMILY	1	\$42.44	\$42.44
124-253-07	RESID. SINGLE FAMILY	1	\$42.44	\$42.44
124-253-08	RESID. SINGLE FAMILY	1	\$42.44	\$42.44
124-253-09	RESID. SINGLE FAMILY	1	\$42.44	\$42.44
124-253-10	RESID. SINGLE FAMILY	1	\$42.44	\$42.44
124-253-11	RESID. SINGLE FAMILY	0.9	\$42.44	\$38.20



APN	Land Use	EDU	Assessment Rate	Assessment
124-253-12	RESID. SINGLE FAMILY	0.9	\$42.44	\$38.20
124-253-13	RESID. SINGLE FAMILY	0.9	\$42.44	\$38.20
124-253-14	RESID. SINGLE FAMILY	0.9	\$42.44	\$38.20
124-253-15	RESID. SINGLE FAMILY	0.9	\$42.44	\$38.20
124-253-16	RESID. SINGLE FAMILY	0.9	\$42.44	\$38.20
124-253-17	RESID. SINGLE FAMILY	0.9	\$42.44	\$38.20
124-253-18	RESID. SINGLE FAMILY	0.9	\$42.44	\$38.20
124-253-19	RESID. SINGLE FAMILY	0.9	\$42.44	\$38.20
124-253-20	RESID. SINGLE FAMILY	0.9	\$42.44	\$38.20
124-253-21	RESID. SINGLE FAMILY	0.9	\$42.44	\$38.20
124-261-01	RESID. SINGLE FAMILY	0.9	\$42.44	\$38.20
124-261-02	RESID. SINGLE FAMILY	0.9	\$42.44	\$38.20
124-261-03	RESID. SINGLE FAMILY	0.9	\$42.44	\$38.20
124-261-04	RESID. SINGLE FAMILY	0.9	\$42.44	\$38.20
124-261-05	RESID. SINGLE FAMILY	0.9	\$42.44	\$38.20
124-261-06	RESID. SINGLE FAMILY	0.9	\$42.44	\$38.20
124-261-07	RESID. SINGLE FAMILY	0.9	\$42.44	\$38.20
124-261-08	RESID. SINGLE FAMILY	0.9	\$42.44	\$38.20
124-261-09	RESID. SINGLE FAMILY	0.9	\$42.44	\$38.20
124-261-10	RESID. SINGLE FAMILY	0.9	\$42.44	\$38.20
124-261-11	RESID. SINGLE FAMILY	0.9	\$42.44	\$38.20
124-261-12	RESID. SINGLE FAMILY	0.9	\$42.44	\$38.20
124-261-13	TAX EXEMPTS	0	\$42.44	\$0.00
124-261-14	RESID. SINGLE FAMILY	0.9	\$42.44	\$38.20
124-261-15	RESID. SINGLE FAMILY	0.9	\$42.44	\$38.20
124-261-16	RESID. SINGLE FAMILY	0.9	\$42.44	\$38.20
124-261-17	RESID. SINGLE FAMILY	0.9	\$42.44	\$38.20
124-261-18	RESID. SINGLE FAMILY	0.9	\$42.44	\$38.20
124-261-36	TAX EXEMPTS	0	\$42.44	\$0.00
124-261-37	TAX EXEMPTS	0	\$42.44	\$0.00
124-261-66	RESID. SINGLE FAMILY	1	\$42.44	\$42.44
124-261-67	RESID. SINGLE FAMILY	1	\$42.44	\$42.44
124-261-68	RESID. SINGLE FAMILY	1	\$42.44	\$42.44
124-261-69	RESID. SINGLE FAMILY	1	\$42.44	\$42.44
124-261-70	RESID. SINGLE FAMILY	1	\$42.44	\$42.44
124-261-71	RESID. SINGLE FAMILY	1	\$42.44	\$42.44
124-261-72	RESID. SINGLE FAMILY	1	\$42.44	\$42.44
124-261-73	RESID. SINGLE FAMILY	1	\$42.44	\$42.44
124-261-74	RESID. SINGLE FAMILY	1	\$42.44	\$42.44
124-261-75	RESID. SINGLE FAMILY	1	\$42.44	\$42.44
124-261-76	RESID. SINGLE FAMILY	1	\$42.44	\$42.44



APN	Land Use	EDU	Assessment Rate	Assessment
124-261-77	RESID. SINGLE FAMILY	1	\$42.44	\$42.44
124-261-78	RESID. SINGLE FAMILY	1	\$42.44	\$42.44
124-261-79	RESID. SINGLE FAMILY	1	\$42.44	\$42.44
124-261-80	RESID. SINGLE FAMILY	1	\$42.44	\$42.44
124-261-81	RESID. SINGLE FAMILY	1	\$42.44	\$42.44
124-261-82	RESID. SINGLE FAMILY	1	\$42.44	\$42.44
124-262-01	RESID. SINGLE FAMILY	0.9	\$42.44	\$38.20
124-262-02	RESID. SINGLE FAMILY	0.9	\$42.44	\$38.20
124-262-03	RESID. SINGLE FAMILY	0.9	\$42.44	\$38.20
124-262-04	RESID. SINGLE FAMILY	0.9	\$42.44	\$38.20
124-262-05	TAX EXEMPTS	0	\$42.44	\$0.00
124-262-06	RESID. SINGLE FAMILY	0.9	\$42.44	\$38.20
124-262-07	RESID. SINGLE FAMILY	0.9	\$42.44	\$38.20
124-262-08	RESID. SINGLE FAMILY	0.9	\$42.44	\$38.20
124-262-09	RESID. SINGLE FAMILY	0.9	\$42.44	\$38.20
124-262-10	RESID. SINGLE FAMILY	0.9	\$42.44	\$38.20
124-262-11	RESID. SINGLE FAMILY	0.9	\$42.44	\$38.20
124-262-12	RESID. SINGLE FAMILY	0.9	\$42.44	\$38.20
124-262-13	RESID. SINGLE FAMILY	0.9	\$42.44	\$38.20
124-262-14	RESID. SINGLE FAMILY	0.9	\$42.44	\$38.20
124-262-15	RESID. SINGLE FAMILY	0.9	\$42.44	\$38.20
124-262-16	RESID. SINGLE FAMILY	0.9	\$42.44	\$38.20
124-271-10	RESID. SINGLE FAMILY	1	\$42.44	\$42.44
124-271-11	RESID. SINGLE FAMILY	1	\$42.44	\$42.44
124-271-12	RESID. SINGLE FAMILY	1	\$42.44	\$42.44
124-271-13	RESID. SINGLE FAMILY	1	\$42.44	\$42.44
124-271-14	RESID. SINGLE FAMILY	1	\$42.44	\$42.44
124-271-15	RESID. SINGLE FAMILY	1	\$42.44	\$42.44
124-271-16	TAX EXEMPTS	0.9	\$42.44	\$38.20
124-271-17	RESID. SINGLE FAMILY	0.9	\$42.44	\$38.20
124-271-18	RESID. SINGLE FAMILY	0.9	\$42.44	\$38.20
124-271-19	RESID. SINGLE FAMILY	0.9	\$42.44	\$38.20
124-271-22	RESID. SINGLE FAMILY	0.9	\$42.44	\$38.20
124-271-23	RESID. SINGLE FAMILY	0.9	\$42.44	\$38.20
124-271-24	RESID. SINGLE FAMILY	0.9	\$42.44	\$38.20
124-271-25	RESID. SINGLE FAMILY	0.9	\$42.44	\$38.20
124-271-26	RESID. SINGLE FAMILY	0.9	\$42.44	\$38.20
124-271-27	RESID. SINGLE FAMILY	0.9	\$42.44	\$38.20
124-271-28	RESID. SINGLE FAMILY	0.9	\$42.44	\$38.20
124-271-29	RESID. SINGLE FAMILY	0.9	\$42.44	\$38.20
124-271-30	COMMERCIAL	4.4056	\$42.44	\$186.96



APN	Land Use	EDU	Assessment Rate	Assessment
124-271-34	RESID. MULTIPLE FAMILY	4.2	\$42.44	\$178.24
124-271-49	RESID. SINGLE FAMILY	0.9	\$42.44	\$38.20
124-271-51	RESID. SINGLE FAMILY	1	\$42.44	\$42.44
124-271-52	RESID. SINGLE FAMILY	1	\$42.44	\$42.44
124-271-53	RESID. SINGLE FAMILY	1	\$42.44	\$42.44
124-271-54	RESID. SINGLE FAMILY	1	\$42.44	\$42.44
124-271-55	RESID. SINGLE FAMILY	1	\$42.44	\$42.44
124-271-56	RESID. SINGLE FAMILY	1	\$42.44	\$42.44
124-271-57	RESID. SINGLE FAMILY	1	\$42.44	\$42.44
124-271-58	RESID. SINGLE FAMILY	1	\$42.44	\$42.44
124-271-59	RESID. SINGLE FAMILY	1	\$42.44	\$42.44
124-271-60	RESID. SINGLE FAMILY	0.9	\$42.44	\$38.20
124-272-01	RESID. SINGLE FAMILY	0.9	\$42.44	\$38.20
124-272-02	RESID. SINGLE FAMILY	0.9	\$42.44	\$38.20
124-272-03	RESID. SINGLE FAMILY	0.9	\$42.44	\$38.20
124-272-04	RESID. SINGLE FAMILY	0.9	\$42.44	\$38.20
124-272-05	RESID. SINGLE FAMILY	0.9	\$42.44	\$38.20
124-272-06	RESID. SINGLE FAMILY	0.9	\$42.44	\$38.20
124-272-07	RESID. SINGLE FAMILY	0.9	\$42.44	\$38.20
124-272-08	RESID. SINGLE FAMILY	0.9	\$42.44	\$38.20
124-272-09	RESID. SINGLE FAMILY	0.9	\$42.44	\$38.20
124-272-10	RESID. SINGLE FAMILY	0.9	\$42.44	\$38.20
124-272-11	RESID. SINGLE FAMILY	0.9	\$42.44	\$38.20
124-272-12	RESID. SINGLE FAMILY	0.9	\$42.44	\$38.20
124-272-13	RESID. SINGLE FAMILY	0.9	\$42.44	\$38.20
124-272-14	RESID. SINGLE FAMILY	0.9	\$42.44	\$38.20
124-281-09	VACANT	0	\$42.44	\$0.00
124-281-48	RESID. SINGLE FAMILY	1	\$42.44	\$42.44
124-281-49	RESID. SINGLE FAMILY	1	\$42.44	\$42.44
124-281-50	RESID. SINGLE FAMILY	1	\$42.44	\$42.44
124-281-51	RESID. SINGLE FAMILY	1	\$42.44	\$42.44
124-281-52	RESID. SINGLE FAMILY	1	\$42.44	\$42.44
124-281-53	RESID. SINGLE FAMILY	1	\$42.44	\$42.44
124-281-54	RESID. SINGLE FAMILY	1	\$42.44	\$42.44
124-281-55	RESID. SINGLE FAMILY	1	\$42.44	\$42.44
124-281-56	RESID. SINGLE FAMILY	1	\$42.44	\$42.44
124-281-57	RESID. SINGLE FAMILY	1	\$42.44	\$42.44
124-281-58	RESID. SINGLE FAMILY	1	\$42.44	\$42.44
124-281-59	RESID. SINGLE FAMILY	1	\$42.44	\$42.44
124-281-60	RESID. SINGLE FAMILY	1	\$42.44	\$42.44
124-281-61	RESID. SINGLE FAMILY	1	\$42.44	\$42.44



APN	Land Use	EDU	Assessment Rate	Assessment
124-281-62	RESID. SINGLE FAMILY	1	\$42.44	\$42.44
124-281-63	RESID. SINGLE FAMILY	1	\$42.44	\$42.44
124-281-64	RESID. SINGLE FAMILY	1	\$42.44	\$42.44
124-282-08	VACANT	0	\$42.44	\$0.00
124-282-18	VACANT	2.4176	\$42.44	\$102.60
124-282-47	RESID. SINGLE FAMILY	1	\$42.44	\$42.44
124-282-48	RESID. SINGLE FAMILY	1	\$42.44	\$42.44
124-282-49	RESID. SINGLE FAMILY	1	\$42.44	\$42.44
124-282-50	RESID. SINGLE FAMILY	1	\$42.44	\$42.44
124-282-51	RESID. SINGLE FAMILY	1	\$42.44	\$42.44
124-282-52	RESID. SINGLE FAMILY	1	\$42.44	\$42.44
124-282-53	RESID. SINGLE FAMILY	1	\$42.44	\$42.44
124-282-54	RESID. SINGLE FAMILY	1	\$42.44	\$42.44
124-282-55	RESID. SINGLE FAMILY	1	\$42.44	\$42.44
124-282-56	RESID. SINGLE FAMILY	1	\$42.44	\$42.44
124-282-57	RESID. SINGLE FAMILY	1	\$42.44	\$42.44
124-282-58	RESID. SINGLE FAMILY	1	\$42.44	\$42.44
124-282-59	RESID. SINGLE FAMILY	1	\$42.44	\$42.44
124-282-60	RESID. SINGLE FAMILY	1	\$42.44	\$42.44
124-282-61	TAX EXEMPTS	1	\$42.44	\$42.44
124-282-62	RESID. SINGLE FAMILY	1	\$42.44	\$42.44
124-282-63	RESID. SINGLE FAMILY	1	\$42.44	\$42.44
124-282-64	RESID. SINGLE FAMILY	1	\$42.44	\$42.44
124-282-65	RESID. SINGLE FAMILY	1	\$42.44	\$42.44
124-282-66	RESID. SINGLE FAMILY	1	\$42.44	\$42.44
124-282-67	RESID. SINGLE FAMILY	1	\$42.44	\$42.44
124-282-68	RESID. SINGLE FAMILY	1	\$42.44	\$42.44
124-282-69	RESID. SINGLE FAMILY	1	\$42.44	\$42.44
124-282-70	RESID. SINGLE FAMILY	1	\$42.44	\$42.44
124-282-71	RESIDENTIAL	0	\$42.44	\$0.00
124-291-37	RESID. SINGLE FAMILY	1	\$42.44	\$42.44
124-291-38	RESID. SINGLE FAMILY	1	\$42.44	\$42.44
124-291-39	RESID. SINGLE FAMILY	1	\$42.44	\$42.44
124-291-40	RESID. SINGLE FAMILY	1	\$42.44	\$42.44
124-291-41	RESID. SINGLE FAMILY	1	\$42.44	\$42.44
124-291-42	RESID. SINGLE FAMILY	1	\$42.44	\$42.44
124-291-44	RESID. SINGLE FAMILY	1	\$42.44	\$42.44
124-291-46	RESID. SINGLE FAMILY	1	\$42.44	\$42.44
124-291-47	RESID. SINGLE FAMILY	1	\$42.44	\$42.44
124-291-48	RESID. SINGLE FAMILY	1	\$42.44	\$42.44
124-291-49	RESID. SINGLE FAMILY	1	\$42.44	\$42.44



APN	Land Use	EDU	Assessment Rate	Assessment
124-291-50	RESID. SINGLE FAMILY	1	\$42.44	\$42.44
124-291-51	VACANT	0	\$42.44	\$0.00
124-291-52	VACANT	0	\$42.44	\$0.00
124-291-55	RESID. SINGLE FAMILY	1	\$42.44	\$42.44
124-291-56	RESID. SINGLE FAMILY	1	\$42.44	\$42.44
124-292-07	RESID. SINGLE FAMILY	1	\$42.44	\$42.44
124-292-08	RESID. SINGLE FAMILY	1	\$42.44	\$42.44
124-292-09	RESID. MULTIPLE FAMILY	5.6	\$42.44	\$237.66
124-293-09	TAX EXEMPTS	0	\$42.44	\$0.00
124-293-11	RESID. SINGLE FAMILY	1	\$42.44	\$42.44
124-293-12	RESID. SINGLE FAMILY	1	\$42.44	\$42.44
124-294-05	RESID. MULTIPLE FAMILY	2.1	\$42.44	\$89.12
124-294-19	RESID. SINGLE FAMILY	0.9	\$42.44	\$38.20
124-294-20	RESID. SINGLE FAMILY	0.9	\$42.44	\$38.20
124-294-21	RESID. SINGLE FAMILY	0.9	\$42.44	\$38.20
124-294-22	RESID. SINGLE FAMILY	0.9	\$42.44	\$38.20
124-294-23	RESID. SINGLE FAMILY	0.9	\$42.44	\$38.20
124-294-24	RESID. SINGLE FAMILY	0.9	\$42.44	\$38.20
124-294-25	RESID. SINGLE FAMILY	0.9	\$42.44	\$38.20
124-294-26	RESID. SINGLE FAMILY	0.9	\$42.44	\$38.20
124-294-27	RESID. SINGLE FAMILY	0.9	\$42.44	\$38.20
124-294-28	RESID. SINGLE FAMILY	0.9	\$42.44	\$38.20
124-294-29	RESID. SINGLE FAMILY	0.9	\$42.44	\$38.20
124-294-30	RESID. SINGLE FAMILY	0.9	\$42.44	\$38.20
124-294-31	RESID. SINGLE FAMILY	0.9	\$42.44	\$38.20
124-294-32	RESID. SINGLE FAMILY	0.9	\$42.44	\$38.20
124-294-33	RESID. SINGLE FAMILY	0.9	\$42.44	\$38.20
124-294-34	RESID. SINGLE FAMILY	0.9	\$42.44	\$38.20
124-294-35	RESID. SINGLE FAMILY	0.9	\$42.44	\$38.20
124-294-36	RESID. SINGLE FAMILY	0.9	\$42.44	\$38.20
124-294-37	RESID. SINGLE FAMILY	0.9	\$42.44	\$38.20
124-294-38	RESID. SINGLE FAMILY	0.9	\$42.44	\$38.20
124-294-39	RESID. SINGLE FAMILY	0.9	\$42.44	\$38.20
124-294-40	RESID. SINGLE FAMILY	0.9	\$42.44	\$38.20
124-294-41	RESID. SINGLE FAMILY	0.9	\$42.44	\$38.20
124-294-42	RESID. SINGLE FAMILY	0.9	\$42.44	\$38.20
124-294-43	RESID. SINGLE FAMILY	0.9	\$42.44	\$38.20
124-294-67	RESID. SINGLE FAMILY	1	\$42.44	\$42.44
124-294-68	RESID. SINGLE FAMILY	1	\$42.44	\$42.44
124-294-69	RESID. SINGLE FAMILY	1	\$42.44	\$42.44
124-294-70	RESID. SINGLE FAMILY	1	\$42.44	\$42.44



APN	Land Use	EDU	Assessment Rate	Assessment
124-294-71	RESID. SINGLE FAMILY	1	\$42.44	\$42.44
124-294-72	RESID. SINGLE FAMILY	1	\$42.44	\$42.44
124-294-73	RESID. SINGLE FAMILY	1	\$42.44	\$42.44
124-294-74	RESID. SINGLE FAMILY	1	\$42.44	\$42.44
124-294-75	RESID. SINGLE FAMILY	1	\$42.44	\$42.44
124-294-76	RESID. SINGLE FAMILY	1	\$42.44	\$42.44
124-294-77	RESID. SINGLE FAMILY	1	\$42.44	\$42.44
124-294-78	RESID. SINGLE FAMILY	1	\$42.44	\$42.44
124-294-79	RESID. MULTIPLE FAMILY	2.1	\$42.44	\$89.12
124-294-80	RESID. MULTIPLE FAMILY	2.1	\$42.44	\$89.12
124-294-81	RESID. MULTIPLE FAMILY	2.1	\$42.44	\$89.12
124-295-01	RESID. SINGLE FAMILY	0.9	\$42.44	\$38.20
124-295-04	RESID. SINGLE FAMILY	0.9	\$42.44	\$38.20
124-295-05	RESID. SINGLE FAMILY	0.9	\$42.44	\$38.20
124-295-06	RESID. SINGLE FAMILY	0.9	\$42.44	\$38.20
124-295-07	RESID. SINGLE FAMILY	0.9	\$42.44	\$38.20
124-295-08	RESID. SINGLE FAMILY	0.9	\$42.44	\$38.20
124-295-10	RESID. SINGLE FAMILY	0.9	\$42.44	\$38.20
124-295-11	RESID. SINGLE FAMILY	0.9	\$42.44	\$38.20
124-296-01	RESID. SINGLE FAMILY	0.9	\$42.44	\$38.20
124-296-02	RESID. SINGLE FAMILY	0.9	\$42.44	\$38.20
124-301-17	RESID. SINGLE FAMILY	1	\$42.44	\$42.44
124-301-18	RESID. SINGLE FAMILY	1	\$42.44	\$42.44
124-301-19	RESID. SINGLE FAMILY	1	\$42.44	\$42.44
124-301-20	RESID. SINGLE FAMILY	1	\$42.44	\$42.44
124-301-21	RESID. SINGLE FAMILY	1	\$42.44	\$42.44
124-301-22	RESID. SINGLE FAMILY	1	\$42.44	\$42.44
124-301-23	RESID. SINGLE FAMILY	1	\$42.44	\$42.44
124-301-24	RESID. SINGLE FAMILY	1	\$42.44	\$42.44
124-301-25	RESID. SINGLE FAMILY	1	\$42.44	\$42.44
124-301-26	RESID. SINGLE FAMILY	1	\$42.44	\$42.44
124-301-27	RESID. SINGLE FAMILY	1	\$42.44	\$42.44
124-301-28	RESID. SINGLE FAMILY	1	\$42.44	\$42.44
124-301-29	RESID. SINGLE FAMILY	1	\$42.44	\$42.44
124-301-30	RESID. SINGLE FAMILY	1	\$42.44	\$42.44
124-301-31	RESID. SINGLE FAMILY	1	\$42.44	\$42.44
124-301-32	RESID. SINGLE FAMILY	1	\$42.44	\$42.44
124-301-33	RESID. SINGLE FAMILY	1	\$42.44	\$42.44
124-301-34	RESID. SINGLE FAMILY	1	\$42.44	\$42.44
124-301-35	RESID. SINGLE FAMILY	1	\$42.44	\$42.44
124-301-36	RESID. SINGLE FAMILY	1	\$42.44	\$42.44



APN	Land Use	EDU	Assessment Rate	Assessment
124-301-37	RESID. SINGLE FAMILY	1	\$42.44	\$42.44
124-301-38	RESID. SINGLE FAMILY	1	\$42.44	\$42.44
124-301-39	RESID. SINGLE FAMILY	1	\$42.44	\$42.44
124-301-40	RESID. SINGLE FAMILY	1	\$42.44	\$42.44
124-301-41	RESIDENTIAL	0	\$42.44	\$0.00
124-301-42	RESIDENTIAL	0	\$42.44	\$0.00
124-302-08	RESID. SINGLE FAMILY	1	\$42.44	\$42.44
124-302-09	RESID. SINGLE FAMILY	1	\$42.44	\$42.44
124-303-03	RESID. SINGLE FAMILY	0.9	\$42.44	\$38.20
124-303-04	RESID. SINGLE FAMILY	0.9	\$42.44	\$38.20
124-303-05	RESID. SINGLE FAMILY	0.9	\$42.44	\$38.20
124-303-06	RESID. SINGLE FAMILY	0.9	\$42.44	\$38.20
124-303-07	RESID. SINGLE FAMILY	0.9	\$42.44	\$38.20
124-303-08	RESID. SINGLE FAMILY	0.9	\$42.44	\$38.20
124-303-13	RESID. SINGLE FAMILY	1	\$42.44	\$42.44
124-303-14	RESID. SINGLE FAMILY	1	\$42.44	\$42.44
124-304-21	RESID. SINGLE FAMILY	1	\$42.44	\$42.44
124-304-22	RESID. SINGLE FAMILY	1	\$42.44	\$42.44
124-304-23	RESID. SINGLE FAMILY	1	\$42.44	\$42.44
124-304-24	RESID. SINGLE FAMILY	1	\$42.44	\$42.44
124-304-25	RESID. SINGLE FAMILY	1	\$42.44	\$42.44
124-304-26	RESID. SINGLE FAMILY	1	\$42.44	\$42.44
124-304-27	RESID. SINGLE FAMILY	1	\$42.44	\$42.44
124-304-28	RESID. SINGLE FAMILY	1	\$42.44	\$42.44
124-304-29	RESID. SINGLE FAMILY	1	\$42.44	\$42.44
124-304-30	RESID. SINGLE FAMILY	1	\$42.44	\$42.44
124-304-31	RESID. SINGLE FAMILY	1	\$42.44	\$42.44
124-304-32	RESID. SINGLE FAMILY	1	\$42.44	\$42.44
124-304-33	RESID. SINGLE FAMILY	1	\$42.44	\$42.44
124-304-34	RESID. SINGLE FAMILY	1	\$42.44	\$42.44
124-304-35	RESID. SINGLE FAMILY	1	\$42.44	\$42.44
124-304-36	RESID. SINGLE FAMILY	1	\$42.44	\$42.44
124-304-37	RESID. SINGLE FAMILY	1	\$42.44	\$42.44
124-304-38	RESID. SINGLE FAMILY	1	\$42.44	\$42.44
124-304-39	RESIDENTIAL	0	\$42.44	\$0.00
124-304-43	RESID. SINGLE FAMILY	1	\$42.44	\$42.44
124-304-46	RESID. SINGLE FAMILY	1	\$42.44	\$42.44
124-304-47	RESID. SINGLE FAMILY	1	\$42.44	\$42.44
124-304-48	RESID. SINGLE FAMILY	1	\$42.44	\$42.44
124-311-10	RESID. SINGLE FAMILY	1	\$42.44	\$42.44
124-311-11	RESID. SINGLE FAMILY	1	\$42.44	\$42.44



APN	Land Use	EDU	Assessment Rate	Assessment
124-311-12	RESID. SINGLE FAMILY	1	\$42.44	\$42.44
124-311-13	RESID. SINGLE FAMILY	1	\$42.44	\$42.44
124-311-14	RESID. SINGLE FAMILY	1	\$42.44	\$42.44
124-311-15	RESID. SINGLE FAMILY	1	\$42.44	\$42.44
124-311-16	RESID. SINGLE FAMILY	1	\$42.44	\$42.44
124-311-17	RESID. SINGLE FAMILY	1	\$42.44	\$42.44
124-311-18	RESID. SINGLE FAMILY	1	\$42.44	\$42.44
124-311-19	RESID. SINGLE FAMILY	1	\$42.44	\$42.44
124-311-20	RESID. SINGLE FAMILY	1	\$42.44	\$42.44
124-311-21	RESID. SINGLE FAMILY	1	\$42.44	\$42.44
124-311-22	RESIDENTIAL	0	\$42.44	\$0.00
124-312-15	RESID. SINGLE FAMILY	1	\$42.44	\$42.44
124-312-16	RESID. SINGLE FAMILY	1	\$42.44	\$42.44
124-312-17	RESID. SINGLE FAMILY	1	\$42.44	\$42.44
124-312-18	RESID. SINGLE FAMILY	1	\$42.44	\$42.44
124-312-19	RESID. SINGLE FAMILY	1	\$42.44	\$42.44
124-312-20	RESID. SINGLE FAMILY	1	\$42.44	\$42.44
124-312-21	RESID. SINGLE FAMILY	1	\$42.44	\$42.44
124-312-22	RESID. SINGLE FAMILY	1	\$42.44	\$42.44
124-312-23	RESID. SINGLE FAMILY	1	\$42.44	\$42.44
124-312-24	RESID. SINGLE FAMILY	1	\$42.44	\$42.44
124-312-25	RESID. SINGLE FAMILY	1	\$42.44	\$42.44
124-312-26	RESID. SINGLE FAMILY	1	\$42.44	\$42.44
124-312-27	RESIDENTIAL	0	\$42.44	\$0.00
124-313-01	RESID. SINGLE FAMILY	1	\$42.44	\$42.44
124-313-02	RESID. SINGLE FAMILY	1	\$42.44	\$42.44
124-313-07	RESID. SINGLE FAMILY	1	\$42.44	\$42.44
124-313-10	RESID. SINGLE FAMILY	1	\$42.44	\$42.44
124-313-11	RESID. SINGLE FAMILY	1	\$42.44	\$42.44
124-313-12	RESID. SINGLE FAMILY	1	\$42.44	\$42.44
124-321-07	RESID. SINGLE FAMILY	1	\$42.44	\$42.44
124-321-08	RESID. SINGLE FAMILY	1	\$42.44	\$42.44
124-321-09	RESID. SINGLE FAMILY	1	\$42.44	\$42.44
124-321-10	RESID. SINGLE FAMILY	1	\$42.44	\$42.44
124-321-11	RESID. SINGLE FAMILY	1	\$42.44	\$42.44
124-321-12	RESID. SINGLE FAMILY	1	\$42.44	\$42.44
124-321-15	RESIDENTIAL	0	\$42.44	\$0.00
124-323-11	TAX EXEMPTS	13.9	\$42.44	\$589.92
124-323-15	RESID. SINGLE FAMILY	1	\$42.44	\$42.44
124-323-16	RESID. SINGLE FAMILY	1	\$42.44	\$42.44
124-323-17	RESID. SINGLE FAMILY	1	\$42.44	\$42.44



APN	Land Use	EDU	Assessment Rate	Assessment
124-323-22	RESID. SINGLE FAMILY	1	\$42.44	\$42.44
124-323-23	RESID. SINGLE FAMILY	1	\$42.44	\$42.44
124-323-26	RESID. SINGLE FAMILY	1	\$42.44	\$42.44
124-323-27	RESIDENTIAL	0	\$42.44	\$0.00
124-331-01	RESID. MULTIPLE FAMILY	2.1	\$42.44	\$89.12
124-332-01	COMMERCIAL	4.94	\$42.44	\$209.64
124-332-07	RESID. SINGLE FAMILY	0.9	\$42.44	\$38.20
124-332-08	RESID. SINGLE FAMILY	0.9	\$42.44	\$38.20
124-332-09	RESID. SINGLE FAMILY	0.9	\$42.44	\$38.20
124-332-10	RESID. SINGLE FAMILY	0.9	\$42.44	\$38.20
124-332-11	RESID. SINGLE FAMILY	0.9	\$42.44	\$38.20
124-332-12	RESID. SINGLE FAMILY	0.9	\$42.44	\$38.20
124-332-13	RESID. SINGLE FAMILY	0.9	\$42.44	\$38.20
124-332-14	RESID. SINGLE FAMILY	0.9	\$42.44	\$38.20
124-332-15	RESID. SINGLE FAMILY	0.9	\$42.44	\$38.20
124-332-19	RESID. SINGLE FAMILY	0.9	\$42.44	\$38.20
124-332-23	RESID. SINGLE FAMILY	0.9	\$42.44	\$38.20
124-332-24	RESID. SINGLE FAMILY	0.9	\$42.44	\$38.20
124-332-25	RESID. SINGLE FAMILY	0.9	\$42.44	\$38.20
124-332-26	RESID. SINGLE FAMILY	0.9	\$42.44	\$38.20
124-332-27	RESID. SINGLE FAMILY	0.9	\$42.44	\$38.20
124-332-28	RESID. SINGLE FAMILY	0.9	\$42.44	\$38.20
124-332-29	RESID. SINGLE FAMILY	0.9	\$42.44	\$38.20
124-332-30	RESID. SINGLE FAMILY	0.9	\$42.44	\$38.20
124-332-34	RESID. SINGLE FAMILY	0.9	\$42.44	\$38.20
124-332-35	RESID. SINGLE FAMILY	0.9	\$42.44	\$38.20
124-332-36	RESID. SINGLE FAMILY	0.9	\$42.44	\$38.20
124-332-38	RESID. SINGLE FAMILY	0.9	\$42.44	\$38.20
124-332-39	RESID. SINGLE FAMILY	0.9	\$42.44	\$38.20
124-332-42	RESID. SINGLE FAMILY	0.9	\$42.44	\$38.20
124-332-45	VACANT	0	\$42.44	\$0.00
124-332-47	RESID. SINGLE FAMILY	0.9	\$42.44	\$38.20
124-332-48	RESID. SINGLE FAMILY	0.9	\$42.44	\$38.20
124-332-52	RESID. SINGLE FAMILY	0.9	\$42.44	\$38.20
124-332-53	RESID. SINGLE FAMILY	0.9	\$42.44	\$38.20
124-332-57	RESID. SINGLE FAMILY	0.9	\$42.44	\$38.20
124-332-66	RESID. SINGLE FAMILY	0.9	\$42.44	\$38.20
124-332-67	RESID. SINGLE FAMILY	0.9	\$42.44	\$38.20
124-332-68	RESID. SINGLE FAMILY	0.9	\$42.44	\$38.20
124-332-69	RESID. SINGLE FAMILY	0.9	\$42.44	\$38.20
124-332-70	RESID. SINGLE FAMILY	0.9	\$42.44	\$38.20



APN	Land Use	EDU	Assessment Rate	Assessment
124-332-71	RESID. SINGLE FAMILY	0.9	\$42.44	\$38.20
124-332-72	RESID. SINGLE FAMILY	0.9	\$42.44	\$38.20
124-332-73	RESID. SINGLE FAMILY	0.9	\$42.44	\$38.20
124-341-02	RESID. SINGLE FAMILY	0.9	\$42.44	\$38.20
124-341-03	RESID. SINGLE FAMILY	0.9	\$42.44	\$38.20
124-341-04	RESID. SINGLE FAMILY	0.9	\$42.44	\$38.20
124-341-05	RESID. SINGLE FAMILY	0.9	\$42.44	\$38.20
124-341-06	RESID. SINGLE FAMILY	0.9	\$42.44	\$38.20
124-341-07	RESID. SINGLE FAMILY	0.9	\$42.44	\$38.20
124-341-08	RESID. SINGLE FAMILY	0.9	\$42.44	\$38.20
124-341-09	RESID. SINGLE FAMILY	0.9	\$42.44	\$38.20
124-341-10	RESID. SINGLE FAMILY	0.9	\$42.44	\$38.20
124-341-11	RESID. SINGLE FAMILY	0.9	\$42.44	\$38.20
124-341-12	RESID. SINGLE FAMILY	0.9	\$42.44	\$38.20
124-341-13	RESID. SINGLE FAMILY	0.9	\$42.44	\$38.20
124-341-15	RESID. SINGLE FAMILY	0.9	\$42.44	\$38.20
124-342-01	RESID. SINGLE FAMILY	0.9	\$42.44	\$38.20
124-342-02	RESID. SINGLE FAMILY	0.9	\$42.44	\$38.20
124-342-07	RESID. SINGLE FAMILY	0.9	\$42.44	\$38.20
124-342-08	RESID. SINGLE FAMILY	0.9	\$42.44	\$38.20
124-342-09	RESID. SINGLE FAMILY	0.9	\$42.44	\$38.20
124-342-10	RESID. SINGLE FAMILY	0.9	\$42.44	\$38.20
124-342-11	RESID. MULTIPLE FAMILY	2	\$42.44	\$84.88
124-342-12	RESID. MULTIPLE FAMILY	2	\$42.44	\$84.88
124-342-13	RESID. MULTIPLE FAMILY	2	\$42.44	\$84.88
124-342-15	RESID. SINGLE FAMILY	0.9	\$42.44	\$38.20
124-361-01	RESID. SINGLE FAMILY	0.9	\$42.44	\$38.20
124-361-02	RESID. SINGLE FAMILY	0.9	\$42.44	\$38.20
124-361-03	RESID. SINGLE FAMILY	0.9	\$42.44	\$38.20
124-362-02	RESID. SINGLE FAMILY	0.9	\$42.44	\$38.20
124-362-03	RESID. SINGLE FAMILY	0.9	\$42.44	\$38.20
124-362-04	RESID. SINGLE FAMILY	0.9	\$42.44	\$38.20
124-362-05	RESID. SINGLE FAMILY	0.9	\$42.44	\$38.20
124-362-06	RESID. SINGLE FAMILY	0.9	\$42.44	\$38.20
124-362-07	RESID. SINGLE FAMILY	0.9	\$42.44	\$38.20
124-362-08	RESID. SINGLE FAMILY	0.9	\$42.44	\$38.20
124-362-09	RESID. SINGLE FAMILY	0.9	\$42.44	\$38.20
124-362-10	RESID. SINGLE FAMILY	0.9	\$42.44	\$38.20
124-362-11	RESID. SINGLE FAMILY	0.9	\$42.44	\$38.20
124-362-12	RESID. SINGLE FAMILY	0.9	\$42.44	\$38.20
124-362-14	RESID. SINGLE FAMILY	0.9	\$42.44	\$38.20



APN	Land Use	EDU	Assessment Rate	Assessment
124-363-02	RESID. SINGLE FAMILY	0.9	\$42.44	\$38.20
124-363-03	RESID. SINGLE FAMILY	0.9	\$42.44	\$38.20
124-363-04	RESID. SINGLE FAMILY	0.9	\$42.44	\$38.20
124-363-06	RESID. SINGLE FAMILY	0.9	\$42.44	\$38.20
124-371-02	RESID. SINGLE FAMILY	0.9	\$42.44	\$38.20
124-371-03	RESID. SINGLE FAMILY	0.9	\$42.44	\$38.20
124-371-05	RESID. SINGLE FAMILY	0.9	\$42.44	\$38.20
124-372-01	RESID. SINGLE FAMILY	0.9	\$42.44	\$38.20
124-372-02	RESID. SINGLE FAMILY	0.9	\$42.44	\$38.20
124-372-03	RESID. SINGLE FAMILY	0.9	\$42.44	\$38.20
124-372-04	RESID. SINGLE FAMILY	0.9	\$42.44	\$38.20
124-372-05	RESID. SINGLE FAMILY	0.9	\$42.44	\$38.20
124-372-06	RESID. SINGLE FAMILY	0.9	\$42.44	\$38.20
124-372-07	RESID. SINGLE FAMILY	0.9	\$42.44	\$38.20
124-372-08	RESID. SINGLE FAMILY	0.9	\$42.44	\$38.20
124-372-09	RESID. SINGLE FAMILY	0.9	\$42.44	\$38.20
124-372-10	RESID. SINGLE FAMILY	0.9	\$42.44	\$38.20
124-372-11	RESID. SINGLE FAMILY	0.9	\$42.44	\$38.20
124-372-12	RESID. SINGLE FAMILY	0.9	\$42.44	\$38.20
124-372-13	RESID. SINGLE FAMILY	0.9	\$42.44	\$38.20
124-372-14	RESID. SINGLE FAMILY	0.9	\$42.44	\$38.20
124-372-15	RESID. SINGLE FAMILY	0.9	\$42.44	\$38.20
124-372-16	RESID. SINGLE FAMILY	0.9	\$42.44	\$38.20
124-372-17	RESID. SINGLE FAMILY	0.9	\$42.44	\$38.20
124-372-18	RESID. SINGLE FAMILY	0.9	\$42.44	\$38.20
124-372-19	RESID. SINGLE FAMILY	0.9	\$42.44	\$38.20
124-372-20	RESID. SINGLE FAMILY	0.9	\$42.44	\$38.20
124-372-21	RESID. SINGLE FAMILY	0.9	\$42.44	\$38.20
124-372-22	RESID. SINGLE FAMILY	0.9	\$42.44	\$38.20
124-372-23	RESID. SINGLE FAMILY	0.9	\$42.44	\$38.20
124-372-24	RESID. SINGLE FAMILY	0.9	\$42.44	\$38.20
124-372-25	RESID. SINGLE FAMILY	0.9	\$42.44	\$38.20
124-372-26	RESID. SINGLE FAMILY	0.9	\$42.44	\$38.20
124-372-27	RESID. SINGLE FAMILY	0.9	\$42.44	\$38.20
124-372-28	RESID. SINGLE FAMILY	0.9	\$42.44	\$38.20
124-372-29	RESID. SINGLE FAMILY	0.9	\$42.44	\$38.20
124-372-30	RESID. SINGLE FAMILY	0.9	\$42.44	\$38.20
124-372-31	RESID. SINGLE FAMILY	0.9	\$42.44	\$38.20
124-373-01	RESID. SINGLE FAMILY	0.9	\$42.44	\$38.20
124-373-02	RESID. SINGLE FAMILY	0.9	\$42.44	\$38.20
124-373-03	RESID. SINGLE FAMILY	0.9	\$42.44	\$38.20



APN	Land Use	EDU	Assessment Rate	Assessment
124-373-04	RESID. SINGLE FAMILY	0.9	\$42.44	\$38.20
124-373-05	RESID. SINGLE FAMILY	0.9	\$42.44	\$38.20
124-373-06	RESID. SINGLE FAMILY	0.9	\$42.44	\$38.20
124-373-07	RESID. SINGLE FAMILY	0.9	\$42.44	\$38.20
124-374-01	RESID. SINGLE FAMILY	0.9	\$42.44	\$38.20
124-374-02	RESID. SINGLE FAMILY	0.9	\$42.44	\$38.20
124-374-03	RESID. SINGLE FAMILY	0.9	\$42.44	\$38.20
124-374-04	RESID. SINGLE FAMILY	0.9	\$42.44	\$38.20
124-374-05	RESID. SINGLE FAMILY	0.9	\$42.44	\$38.20
124-375-01	RESID. SINGLE FAMILY	0.9	\$42.44	\$38.20
124-375-02	RESID. SINGLE FAMILY	0.9	\$42.44	\$38.20
124-375-03	RESID. SINGLE FAMILY	0.9	\$42.44	\$38.20
124-375-04	RESID. MULTIPLE FAMILY	1.8	\$42.44	\$76.38
124-375-05	RESID. SINGLE FAMILY	0.9	\$42.44	\$38.20
124-375-06	RESID. SINGLE FAMILY	0.9	\$42.44	\$38.20
124-375-07	RESID. SINGLE FAMILY	0.9	\$42.44	\$38.20
124-375-08	RESID. SINGLE FAMILY	0.9	\$42.44	\$38.20
124-375-09	RESID. SINGLE FAMILY	0.9	\$42.44	\$38.20
124-375-10	RESID. SINGLE FAMILY	0.9	\$42.44	\$38.20
124-375-11	RESID. SINGLE FAMILY	0.9	\$42.44	\$38.20
124-375-12	RESID. SINGLE FAMILY	0.9	\$42.44	\$38.20
124-375-13	RESID. SINGLE FAMILY	0.9	\$42.44	\$38.20
124-375-14	RESID. SINGLE FAMILY	0.9	\$42.44	\$38.20
124-375-15	RESID. SINGLE FAMILY	0.9	\$42.44	\$38.20
124-375-16	RESID. SINGLE FAMILY	0.9	\$42.44	\$38.20
124-381-01	RESID. SINGLE FAMILY	0.9	\$42.44	\$38.20
124-381-02	RESID. SINGLE FAMILY	0.9	\$42.44	\$38.20
124-381-03	RESID. SINGLE FAMILY	0.9	\$42.44	\$38.20
124-382-02	RESID. SINGLE FAMILY	0.9	\$42.44	\$38.20
124-382-03	RESID. SINGLE FAMILY	0.9	\$42.44	\$38.20
124-382-04	RESID. SINGLE FAMILY	0.9	\$42.44	\$38.20
124-382-05	RESID. SINGLE FAMILY	0.9	\$42.44	\$38.20
124-382-07	RESID. SINGLE FAMILY	0.9	\$42.44	\$38.20
124-383-01	RESID. SINGLE FAMILY	0.9	\$42.44	\$38.20
124-383-03	RESID. SINGLE FAMILY	0.9	\$42.44	\$38.20
124-383-04	RESID. SINGLE FAMILY	0.9	\$42.44	\$38.20
124-383-05	RESID. SINGLE FAMILY	0.9	\$42.44	\$38.20
124-383-06	RESID. SINGLE FAMILY	0.9	\$42.44	\$38.20
124-383-07	RESID. SINGLE FAMILY	0.9	\$42.44	\$38.20
124-383-08	RESID. SINGLE FAMILY	0.9	\$42.44	\$38.20
124-383-10	RESID. SINGLE FAMILY	0.9	\$42.44	\$38.20



APN	Land Use	EDU	Assessment Rate	Assessment
124-383-11	RESID. SINGLE FAMILY	0.9	\$42.44	\$38.20
124-383-12	RESID. SINGLE FAMILY	0.9	\$42.44	\$38.20
124-383-13	RESID. SINGLE FAMILY	0.9	\$42.44	\$38.20
124-383-14	RESID. SINGLE FAMILY	0.9	\$42.44	\$38.20
124-383-15	RESID. SINGLE FAMILY	0.9	\$42.44	\$38.20
124-383-17	RESID. SINGLE FAMILY	0.9	\$42.44	\$38.20
124-384-01	RESID. SINGLE FAMILY	0.9	\$42.44	\$38.20
124-384-02	RESID. SINGLE FAMILY	0.9	\$42.44	\$38.20
124-384-03	RESID. SINGLE FAMILY	0.9	\$42.44	\$38.20
124-391-01	RESID. SINGLE FAMILY	0.9	\$42.44	\$38.20
124-391-02	RESID. SINGLE FAMILY	0.9	\$42.44	\$38.20
124-391-03	RESID. SINGLE FAMILY	0.9	\$42.44	\$38.20
124-391-04	RESID. SINGLE FAMILY	0.9	\$42.44	\$38.20
124-391-05	RESID. SINGLE FAMILY	0.9	\$42.44	\$38.20
124-391-06	RESID. SINGLE FAMILY	0.9	\$42.44	\$38.20
124-391-07	RESID. SINGLE FAMILY	0.9	\$42.44	\$38.20
124-391-08	RESID. SINGLE FAMILY	0.9	\$42.44	\$38.20
124-391-09	RESID. SINGLE FAMILY	0.9	\$42.44	\$38.20
124-391-12	RESID. SINGLE FAMILY	0.9	\$42.44	\$38.20
124-391-13	RESID. SINGLE FAMILY	0.9	\$42.44	\$38.20
124-391-14	RESID. SINGLE FAMILY	0.9	\$42.44	\$38.20
124-391-15	RESID. SINGLE FAMILY	0.9	\$42.44	\$38.20
124-391-16	RESID. SINGLE FAMILY	0.9	\$42.44	\$38.20
124-391-17	RESID. SINGLE FAMILY	0.9	\$42.44	\$38.20
124-392-01	RESID. SINGLE FAMILY	0.9	\$42.44	\$38.20
124-392-02	RESID. SINGLE FAMILY	0.9	\$42.44	\$38.20
124-392-03	RESID. SINGLE FAMILY	0.9	\$42.44	\$38.20
124-392-04	RESID. SINGLE FAMILY	0.9	\$42.44	\$38.20
124-392-05	RESID. SINGLE FAMILY	0.9	\$42.44	\$38.20
124-392-06	RESID. SINGLE FAMILY	0.9	\$42.44	\$38.20
124-392-07	RESID. SINGLE FAMILY	0.9	\$42.44	\$38.20
124-392-08	RESID. SINGLE FAMILY	0.9	\$42.44	\$38.20
124-392-09	RESID. SINGLE FAMILY	0.9	\$42.44	\$38.20
124-392-10	RESID. SINGLE FAMILY	0.9	\$42.44	\$38.20
124-392-11	RESID. SINGLE FAMILY	0.9	\$42.44	\$38.20
124-392-12	RESID. SINGLE FAMILY	0.9	\$42.44	\$38.20
124-392-13	RESID. SINGLE FAMILY	0.9	\$42.44	\$38.20
124-392-14	RESID. SINGLE FAMILY	0.9	\$42.44	\$38.20
124-393-01	RESID. SINGLE FAMILY	0.9	\$42.44	\$38.20
124-393-02	RESID. SINGLE FAMILY	0.9	\$42.44	\$38.20
124-393-03	RESID. SINGLE FAMILY	0.9	\$42.44	\$38.20



APN	Land Use	EDU	Assessment Rate	Assessment
124-393-04	RESID. SINGLE FAMILY	0.9	\$42.44	\$38.20
124-393-05	RESID. SINGLE FAMILY	0.9	\$42.44	\$38.20
124-401-01	RESID. SINGLE FAMILY	0.9	\$42.44	\$38.20
124-401-02	RESID. SINGLE FAMILY	0.9	\$42.44	\$38.20
124-401-03	RESID. SINGLE FAMILY	0.9	\$42.44	\$38.20
124-401-04	RESID. SINGLE FAMILY	0.9	\$42.44	\$38.20
124-401-05	RESID. SINGLE FAMILY	0.9	\$42.44	\$38.20
124-401-06	RESID. SINGLE FAMILY	0.9	\$42.44	\$38.20
124-402-01	RESID. SINGLE FAMILY	0.9	\$42.44	\$38.20
124-402-02	RESID. SINGLE FAMILY	0.9	\$42.44	\$38.20
124-402-03	RESID. SINGLE FAMILY	0.9	\$42.44	\$38.20
124-402-04	RESID. SINGLE FAMILY	0.9	\$42.44	\$38.20
124-402-05	RESID. SINGLE FAMILY	0.9	\$42.44	\$38.20
124-402-06	RESID. SINGLE FAMILY	0.9	\$42.44	\$38.20
124-402-07	RESID. SINGLE FAMILY	0.9	\$42.44	\$38.20
124-402-08	RESID. SINGLE FAMILY	0.9	\$42.44	\$38.20
124-402-09	VACANT	0.45	\$42.44	\$19.10
124-402-12	TAX EXEMPTS	0	\$42.44	\$0.00
124-402-14	RESID. SINGLE FAMILY	0.9	\$42.44	\$38.20
124-402-15	RESID. SINGLE FAMILY	0.9	\$42.44	\$38.20
124-403-01	RESID. SINGLE FAMILY	0.9	\$42.44	\$38.20
124-403-02	RESID. SINGLE FAMILY	0.9	\$42.44	\$38.20
124-403-03	RESID. SINGLE FAMILY	0.9	\$42.44	\$38.20
124-403-04	RESID. SINGLE FAMILY	0.9	\$42.44	\$38.20
124-403-05	RESID. SINGLE FAMILY	0.9	\$42.44	\$38.20
124-404-01	RESID. SINGLE FAMILY	0.9	\$42.44	\$38.20
124-404-02	RESID. SINGLE FAMILY	0.9	\$42.44	\$38.20
124-404-03	RESID. SINGLE FAMILY	0.9	\$42.44	\$38.20
124-404-04	RESID. SINGLE FAMILY	0.9	\$42.44	\$38.20
124-411-02	RESID. SINGLE FAMILY	0.9	\$42.44	\$38.20
124-411-03	RESID. SINGLE FAMILY	0.9	\$42.44	\$38.20
124-411-04	RESID. SINGLE FAMILY	0.9	\$42.44	\$38.20
124-411-05	RESID. SINGLE FAMILY	0.9	\$42.44	\$38.20
124-411-06	RESID. SINGLE FAMILY	0.9	\$42.44	\$38.20
124-411-07	RESID. SINGLE FAMILY	0.9	\$42.44	\$38.20
124-411-08	RESID. SINGLE FAMILY	0.9	\$42.44	\$38.20
124-411-09	RESID. SINGLE FAMILY	0.9	\$42.44	\$38.20
124-411-10	RESID. SINGLE FAMILY	0.9	\$42.44	\$38.20
124-411-11	VACANT	0.45	\$42.44	\$19.10
124-440-01	RESID. SINGLE FAMILY	0.9	\$42.44	\$38.20
124-440-02	RESID. SINGLE FAMILY	0.9	\$42.44	\$38.20



APN	Land Use	EDU	Assessment Rate	Assessment
124-440-03	RESID. SINGLE FAMILY	0.9	\$42.44	\$38.20
124-440-04	RESID. SINGLE FAMILY	0.9	\$42.44	\$38.20
124-440-05	RESID. SINGLE FAMILY	0.9	\$42.44	\$38.20
124-440-06	RESID. SINGLE FAMILY	0.9	\$42.44	\$38.20
124-440-07	RESID. SINGLE FAMILY	0.9	\$42.44	\$38.20
124-440-08	RESID. SINGLE FAMILY	0.9	\$42.44	\$38.20
124-440-09	RESID. SINGLE FAMILY	0.9	\$42.44	\$38.20
124-440-10	RESID. SINGLE FAMILY	0.9	\$42.44	\$38.20
124-440-11	RESID. SINGLE FAMILY	0.9	\$42.44	\$38.20
124-440-12	RESID. SINGLE FAMILY	0.9	\$42.44	\$38.20
124-440-13	RESID. SINGLE FAMILY	0.9	\$42.44	\$38.20
124-440-14	RESID. SINGLE FAMILY	0.9	\$42.44	\$38.20
124-440-15	RESID. SINGLE FAMILY	0.9	\$42.44	\$38.20
124-440-16	RESID. SINGLE FAMILY	0.9	\$42.44	\$38.20
124-440-17	RESID. SINGLE FAMILY	0.9	\$42.44	\$38.20
124-440-18	RESID. SINGLE FAMILY	0.9	\$42.44	\$38.20
124-440-19	RESID. SINGLE FAMILY	0.9	\$42.44	\$38.20
124-440-20	RESID. SINGLE FAMILY	0.9	\$42.44	\$38.20
124-440-21	RESID. SINGLE FAMILY	0.9	\$42.44	\$38.20
124-440-22	RESID. SINGLE FAMILY	0.9	\$42.44	\$38.20
124-440-23	RESID. SINGLE FAMILY	0.9	\$42.44	\$38.20
124-440-24	RESID. SINGLE FAMILY	0.9	\$42.44	\$38.20
124-440-25	RESID. SINGLE FAMILY	0.9	\$42.44	\$38.20
124-440-27	RESID. SINGLE FAMILY	0	\$42.44	\$0.00
124-450-01	RESID. SINGLE FAMILY	0.9	\$42.44	\$38.20
124-450-02	RESID. SINGLE FAMILY	0.9	\$42.44	\$38.20
124-450-03	RESID. SINGLE FAMILY	0.9	\$42.44	\$38.20
124-450-04	RESID. SINGLE FAMILY	0.9	\$42.44	\$38.20
124-450-05	RESID. SINGLE FAMILY	0.9	\$42.44	\$38.20
124-450-06	RESID. SINGLE FAMILY	0.9	\$42.44	\$38.20
124-450-07	RESID. SINGLE FAMILY	0.9	\$42.44	\$38.20
124-450-08	RESID. SINGLE FAMILY	0.9	\$42.44	\$38.20
124-460-01	RESID. SINGLE FAMILY	0.9	\$42.44	\$38.20
124-460-02	RESID. SINGLE FAMILY	0.9	\$42.44	\$38.20
124-460-03	RESID. SINGLE FAMILY	0.9	\$42.44	\$38.20
124-460-04	RESID. SINGLE FAMILY	0.9	\$42.44	\$38.20
124-460-06	RESID. SINGLE FAMILY	0.9	\$42.44	\$38.20
124-460-07	RESID. SINGLE FAMILY	0.9	\$42.44	\$38.20
124-460-11	RESID. SINGLE FAMILY	0.9	\$42.44	\$38.20
124-470-04	RESID. SINGLE FAMILY	0.9	\$42.44	\$38.20
124-470-05	RESID. SINGLE FAMILY	0.9	\$42.44	\$38.20



APN	Land Use	EDU	Assessment Rate	Assessment
124-470-06	RESID. SINGLE FAMILY	0.9	\$42.44	\$38.20
124-470-07	RESID. SINGLE FAMILY	0.9	\$42.44	\$38.20
124-470-08	RESID. SINGLE FAMILY	0.9	\$42.44	\$38.20
124-470-09	RESID. SINGLE FAMILY	0.9	\$42.44	\$38.20
124-470-10	RESID. SINGLE FAMILY	0.9	\$42.44	\$38.20
124-470-11	RESID. SINGLE FAMILY	0.9	\$42.44	\$38.20
124-470-12	RESID. SINGLE FAMILY	0.9	\$42.44	\$38.20
124-470-13	RESID. SINGLE FAMILY	0.9	\$42.44	\$38.20
124-470-14	RESID. SINGLE FAMILY	0.9	\$42.44	\$38.20
124-470-15	RESID. SINGLE FAMILY	0.9	\$42.44	\$38.20
124-470-16	RESID. SINGLE FAMILY	0.9	\$42.44	\$38.20
124-470-17	RESID. SINGLE FAMILY	0.9	\$42.44	\$38.20
124-470-18	RESID. SINGLE FAMILY	0.9	\$42.44	\$38.20
124-470-19	RESID. SINGLE FAMILY	0.9	\$42.44	\$38.20
124-470-20	RESID. SINGLE FAMILY	0.9	\$42.44	\$38.20
124-470-21	RESID. SINGLE FAMILY	0.9	\$42.44	\$38.20
124-470-22	RESID. SINGLE FAMILY	0.9	\$42.44	\$38.20
124-470-23	RESID. SINGLE FAMILY	0.9	\$42.44	\$38.20
125-341-01	RESID. SINGLE FAMILY	0.9	\$42.44	\$38.20
125-341-02	RESID. SINGLE FAMILY	0.9	\$42.44	\$38.20
125-341-03	RESID. SINGLE FAMILY	0.9	\$42.44	\$38.20
125-341-04	RESID. SINGLE FAMILY	0.9	\$42.44	\$38.20
125-341-05	RESID. SINGLE FAMILY	0.9	\$42.44	\$38.20
125-341-06	RESID. SINGLE FAMILY	0.9	\$42.44	\$38.20
125-341-07	RESID. SINGLE FAMILY	0.9	\$42.44	\$38.20
125-341-08	RESID. SINGLE FAMILY	0.9	\$42.44	\$38.20
125-341-09	RESID. SINGLE FAMILY	0.9	\$42.44	\$38.20
125-341-10	RESID. SINGLE FAMILY	0.9	\$42.44	\$38.20
125-341-11	RESID. SINGLE FAMILY	0.9	\$42.44	\$38.20
125-341-12	RESID. SINGLE FAMILY	0.9	\$42.44	\$38.20
125-341-13	RESID. SINGLE FAMILY	0.9	\$42.44	\$38.20
125-341-14	RESID. SINGLE FAMILY	0.9	\$42.44	\$38.20
125-341-15	RESID. SINGLE FAMILY	0.9	\$42.44	\$38.20
125-341-16	RESID. SINGLE FAMILY	0.9	\$42.44	\$38.20
125-342-01	RESID. SINGLE FAMILY	0.9	\$42.44	\$38.20
125-342-02	RESID. SINGLE FAMILY	0.9	\$42.44	\$38.20
125-342-03	RESID. SINGLE FAMILY	0.9	\$42.44	\$38.20
125-342-04	RESID. SINGLE FAMILY	0.9	\$42.44	\$38.20
125-342-05	RESID. SINGLE FAMILY	0.9	\$42.44	\$38.20
125-342-06	RESID. SINGLE FAMILY	0.9	\$42.44	\$38.20
125-342-07	RESID. SINGLE FAMILY	0.9	\$42.44	\$38.20



APN	Land Use	EDU	Assessment Rate	Assessment
125-342-08	RESID. SINGLE FAMILY	0.9	\$42.44	\$38.20
125-342-09	RESID. SINGLE FAMILY	0.9	\$42.44	\$38.20
125-342-10	RESID. SINGLE FAMILY	0.9	\$42.44	\$38.20
125-342-11	RESID. SINGLE FAMILY	0.9	\$42.44	\$38.20
125-342-12	RESID. SINGLE FAMILY	0.9	\$42.44	\$38.20
125-342-13	TAX EXEMPTS	0	\$42.44	\$0.00
125-343-01	RESID. SINGLE FAMILY	0.9	\$42.44	\$38.20
125-343-02	RESID. SINGLE FAMILY	0.9	\$42.44	\$38.20
125-343-03	RESID. SINGLE FAMILY	0.9	\$42.44	\$38.20
125-343-04	RESID. SINGLE FAMILY	0.9	\$42.44	\$38.20
125-343-05	RESID. SINGLE FAMILY	0.9	\$42.44	\$38.20
125-343-06	RESID. SINGLE FAMILY	0.9	\$42.44	\$38.20
125-343-09	RESID. SINGLE FAMILY	0.9	\$42.44	\$38.20
125-343-10	RESID. SINGLE FAMILY	0.9	\$42.44	\$38.20
125-343-13	RESID. SINGLE FAMILY	0.9	\$42.44	\$38.20
125-343-14	RESID. SINGLE FAMILY	0.9	\$42.44	\$38.20
125-343-15	RESID. SINGLE FAMILY	0.9	\$42.44	\$38.20
125-343-16	RESID. SINGLE FAMILY	0.9	\$42.44	\$38.20
125-343-17	RESID. SINGLE FAMILY	0.9	\$42.44	\$38.20
125-343-18	RESID. SINGLE FAMILY	0.9	\$42.44	\$38.20
125-343-19	RESID. SINGLE FAMILY	0.9	\$42.44	\$38.20
125-343-20	RESID. SINGLE FAMILY	0.9	\$42.44	\$38.20
125-343-21	RESID. SINGLE FAMILY	0.9	\$42.44	\$38.20
125-343-22	RESID. SINGLE FAMILY	0.9	\$42.44	\$38.20
125-343-23	RESID. SINGLE FAMILY	0.9	\$42.44	\$38.20
125-343-25	RESID. SINGLE FAMILY	0.9	\$42.44	\$38.20
125-343-26	RESID. SINGLE FAMILY	0.9	\$42.44	\$38.20
125-343-27	RESID. SINGLE FAMILY	0.9	\$42.44	\$38.20
125-343-28	RESID. SINGLE FAMILY	0.9	\$42.44	\$38.20
125-343-29	RESID. SINGLE FAMILY	0.9	\$42.44	\$38.20
125-343-30	VACANT	0	\$42.44	\$0.00
125-343-31	RESID. SINGLE FAMILY	0.9	\$42.44	\$38.20
125-351-01	RESID. SINGLE FAMILY	0.9	\$42.44	\$38.20
125-351-02	RESID. SINGLE FAMILY	0.9	\$42.44	\$38.20
125-351-03	RESID. SINGLE FAMILY	0.9	\$42.44	\$38.20
125-351-04	RESID. SINGLE FAMILY	0.9	\$42.44	\$38.20
125-351-05	RESID. SINGLE FAMILY	0.9	\$42.44	\$38.20
125-351-06	RESID. SINGLE FAMILY	0.9	\$42.44	\$38.20
125-351-07	RESID. SINGLE FAMILY	0.9	\$42.44	\$38.20
125-351-08	RESID. SINGLE FAMILY	0.9	\$42.44	\$38.20
125-351-09	RESID. SINGLE FAMILY	0.9	\$42.44	\$38.20



APN	Land Use	EDU	Assessment Rate	Assessment
125-351-10	RESID. SINGLE FAMILY	0.9	\$42.44	\$38.20
125-351-11	RESID. SINGLE FAMILY	0.9	\$42.44	\$38.20
125-351-12	RESID. SINGLE FAMILY	0.9	\$42.44	\$38.20
125-351-13	RESID. SINGLE FAMILY	0.9	\$42.44	\$38.20
125-351-14	RESID. SINGLE FAMILY	0.9	\$42.44	\$38.20
125-351-15	RESID. SINGLE FAMILY	0.9	\$42.44	\$38.20
125-351-16	RESID. SINGLE FAMILY	0.9	\$42.44	\$38.20
125-351-17	RESID. SINGLE FAMILY	0.9	\$42.44	\$38.20
125-352-01	RESID. SINGLE FAMILY	0.9	\$42.44	\$38.20
125-352-02	RESID. SINGLE FAMILY	0.9	\$42.44	\$38.20
125-352-03	RESID. SINGLE FAMILY	0.9	\$42.44	\$38.20
125-352-04	RESID. SINGLE FAMILY	0.9	\$42.44	\$38.20
125-352-05	RESID. SINGLE FAMILY	0.9	\$42.44	\$38.20
125-352-06	RESID. SINGLE FAMILY	0.9	\$42.44	\$38.20
125-352-07	RESID. SINGLE FAMILY	0.9	\$42.44	\$38.20
125-353-01	RESID. SINGLE FAMILY	0.9	\$42.44	\$38.20
125-353-02	RESID. SINGLE FAMILY	0.9	\$42.44	\$38.20
125-353-03	RESID. SINGLE FAMILY	0.9	\$42.44	\$38.20
125-353-04	RESID. SINGLE FAMILY	0.9	\$42.44	\$38.20
125-353-07	RESID. SINGLE FAMILY	0.9	\$42.44	\$38.20
125-353-08	RESID. SINGLE FAMILY	0.9	\$42.44	\$38.20
125-353-09	RESID. SINGLE FAMILY	0.9	\$42.44	\$38.20
125-353-10	RESID. SINGLE FAMILY	0.9	\$42.44	\$38.20
125-353-11	RESID. SINGLE FAMILY	0.9	\$42.44	\$38.20
125-353-12	RESID. SINGLE FAMILY	0.9	\$42.44	\$38.20
125-353-14	RESID. SINGLE FAMILY	0.9	\$42.44	\$38.20
125-353-15	RESID. SINGLE FAMILY	0.9	\$42.44	\$38.20
125-354-01	TAX EXEMPTS	0	\$42.44	\$0.00
125-361-02	TAX EXEMPTS	0	\$42.44	\$0.00
125-361-03	COMMERCIAL	5.4537	\$42.44	\$231.46
125-361-04	COMMERCIAL	5.4537	\$42.44	\$231.46
141-051-01	RESID. SINGLE FAMILY	0	\$42.44	\$0.00
141-051-02	RESID. SINGLE FAMILY	0.9	\$42.44	\$38.20
141-051-03	RESID. SINGLE FAMILY	0.9	\$42.44	\$38.20
141-051-04	RESID. SINGLE FAMILY	0.9	\$42.44	\$38.20
141-051-06	TAX EXEMPTS	0.9	\$42.44	\$38.20
141-051-07	RESID. SINGLE FAMILY	0.9	\$42.44	\$38.20
141-051-08	RESID. SINGLE FAMILY	0.9	\$42.44	\$38.20
141-051-09	RESID. SINGLE FAMILY	0.9	\$42.44	\$38.20
141-051-10	RESID. SINGLE FAMILY	0.9	\$42.44	\$38.20
141-051-11	RESID. SINGLE FAMILY	0.9	\$42.44	\$38.20



APN	Land Use	EDU	Assessment Rate	Assessment
141-051-12	RESID. SINGLE FAMILY	0.9	\$42.44	\$38.20
141-051-13	RESID. SINGLE FAMILY	0.9	\$42.44	\$38.20
141-051-14	RESID. SINGLE FAMILY	0.9	\$42.44	\$38.20
141-051-15	RESID. SINGLE FAMILY	0.9	\$42.44	\$38.20
141-051-17	VACANT - ROAD	0	\$42.44	\$0.00
141-051-18	VACANT - ROAD	0	\$42.44	\$0.00
141-051-19	VACANT - ROAD	0	\$42.44	\$0.00
141-051-26	RESID. SINGLE FAMILY	<u>0.9</u>	\$42.44	\$38.20
		1,584.81		\$67,264.68